



Brisbane Soil Testing

76 Groth Road

Boondall, Q. 4034

Ph.(07) 3865 8933 Fax.(07) 3265 3705

Ph.(07) 3265 2033 Email. brissoil@bigpond.net.au

Connemar Pty. Ltd.

ABN 50 065 093 647

Geotechnical Testing Services.



Job No.2889

30 May 2013

BMD Constructions Pty Ltd
PO Box 197
WYNNUM CENTRAL QLD 4178

Attn Mr Peter Kavanagh

Dear Sir,

RE: CAPESTONE ESTATE – STAGE 2A
(Allotment Fill – Geotechnical Inspection & Testing)

SCOPE

Brisbane Soil Testing were commissioned by BMD Constructions Pty Ltd to provide geotechnical inspection and testing of the earthworks on the above development.

Some filling was required as part of the development and for this work, our site presence was maintained in accordance with AS3798-2007 "Guidelines on Earthworks for Commercial and Residential Developments" Appendix B, "Level 1". As directed the scope of the Level 1 inspection and testing was:

- (i) check adequacy of pre-fill ground preparation
- (ii) inspect and carry out compaction control testing of placed fill materials

CONTROL INSPECTION AND TESTING

An inspection of area to be filled was carried out on 17 December 2008 and on an ongoing basis as the job progressed.

On-site cut materials were used for filling and these materials were generally placed in 0.20m loose horizontal layers and compacted with an 815 Compactor and a pad foot vibrating roller.

Two hundred and thirty field density tests were carried out between 17 December 2008 and 11 December 2009, and also between 14 December 2012 and 10 May 2013. These tests recorded Dry Density Ratios between 95.0% and 105.5% relative to the standard compaction test and field moisture contents within -6.0% and +6.5% of their respective optimum moisture contents, AS1289.5.1.1.

Attached document B37/5 (Report Nos. 31452, 31453, 31454, 31455, 31456, 31457, 31458, 31459, 31460, 31461, 31462, 31463, 31464, 31465, 31466, 31467, 27145, 31468, 31469, 31470, 31471, 31472, 31475, 71476, 31491, 31492, 31493, 31500, 31502, 31503, 31507, 3159, 31530, 31531, 31540, 31546, 31559, 31568, 31571, 31579, 31608, 31654, 31699, 31719, 31738, 31739, 31843, 31886, 31887, 31940, 31914, 31918, 31927, 31941 and 31931) provide full test data for the compaction control tests.

CONCLUSION

We confirm that vegetation, topsoil, and unsuitable materials were removed and that a sound base for the proposed filling was provided. We further confirm that all filling to design final level can be termed controlled filling in accordance with Section 6.4.2. of AS2870-2011, via a "Level 1" inspection and testing commission, and that the required 95% density ratio has been achieved.



GREG McGRANN
BRISBANE SOIL TESTING



ACCREDITED FOR
**TECHNICAL
COMPETENCE**

Accredited Laboratory No.2415



Brisbane Soil Testing

76 Groth Road
Boondall, Q. 4034

**EARTHWORKS SUMMARY REPORT
CAPESTONE ESTATE – STAGE 2A
LOT 111**

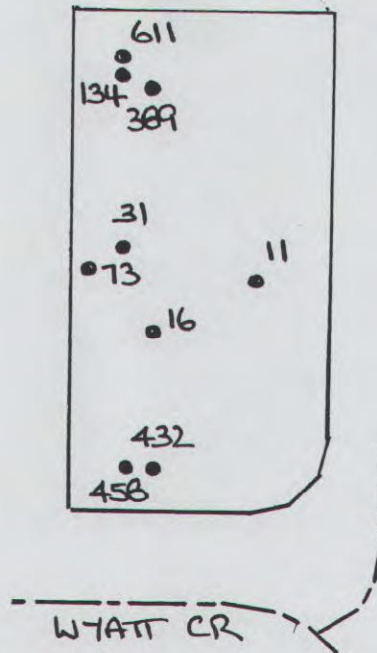

Field Density Results

Test No.	Date Tested	Test Location	Dry Density Ratio AS1289 5.4.1 (Standard)
11	5.01.09	o/s 18m Front bdy, o/s 6m Right bdy. R.L.2.23.	100.5
16	6.01.09	o/s 16m Front bdy, o/s 7m Left bdy. R.L.2.60.	99.0
31	9.01.09	o/s 20m Front bdy, o/s 3m Left bdy. R.L.3.04.	102.5
73	19.01.09	o/s 19m Front bdy, o/s 1m Left bdy. R.L.3.70.	100.5
134	23.02.09	o/s 4m North bdy, o/s 2m West bdy. R.L.4.60.	98.5
389	15.01.13	o/s 6m Rear bdy, o/s 6m Left bdy. R.L.2.93.	101.0
432	23.01.13	o/s 4m Front bdy, o/s 7m Left bdy. R.L.4.94.	98.5
458	2.02.13	o/s 4m Front bdy, o/s 6m Left bdy. R.L.5.36.	101.0
611	30.04.13	o/s 3m Rear bdy, o/s 4m Left bdy. R.L.5.79.	99.5

In our opinion fill on Lot 111 has been placed in a controlled manner to achieve a minimum dry density ratio of 95% to (AS1289.5.1.1 Standard Compaction). We confirm that filling to design final level can be termed controlled filling in accordance with Section 6.4.2. of AS2870-2011, via a "Level 1" inspection and testing commission.

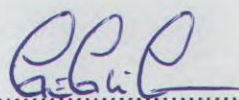
.....
GREG McGRANN



Brisbane Soil Testing
76 Groth Road
Boondall, Q. 4034
Ph. (07) 3265 2033

NATA Reg. No. 2415