

Capestone
For
Urbex

IMPORTANT NOTES:
This plan was prepared to support a Reconfiguration of Lot application for the land situated at Mango Hill. The Contours, boundaries, creek line, flood lines, building locations have all been scaled and should not have any reliance based on them as they are only intended as a general guide. The configuration of allotments shown on this plan is subject to Local Authority (and relevant State Government Authority) approvals, detailed design, final survey, and registration of survey plans. Any comments contained on this plan should be confirmed by the relevant authorities. The dimensions, areas and total number of lots shown hereon are subject to field survey and also to the requirements of Council and any other authority which may have requirements under any relevant legislation. In particular, no reliance should be placed on the information on this plan for any financial dealings involving the land.

Copyright © Queensland Surveying Pty Ltd, a Veris Company, February 2017.

THESE DESIGNS AND DRAWINGS ARE COPYRIGHT AND ARE NOT TO BE USED OR REPRODUCED WITHOUT THE WRITTEN PERMISSION OF VERIS

Data Sources
Cadastral Boundaries 30105-LP22-E.dwg

Issue	Revisions	Date	Drawn
F	Amend Layout/Lot Mix	11.12.2017	KS
E	Amend Layout/Lot Mix	31.08.2017	KS/SI
D	Amendments to road layout	14.08.2017	KS/SI
C	Amendments to lot / lake layout	08.02.2017	KS/SI
B	Add Road Intersection/Turn lots	18.11.2016	KS/SI
A	Original	02.11.2016	KS

Scale: 1:1,000@A2
 Drawn: KS
 Checked: KS
 Plot Date: 11 Dec, 2017
 Computer File Ref: 30105-LP22-F.dwg

CAPESTONE
Stage 20A
Reconfiguration of a Lot Plan

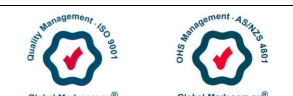

BRISBANE WHITSUNDAYS
(07) 3666 4700 (07) 4945 1722
 MACKAY CAIRNS
(07) 4951 2911 (07) 4051 6722

veris.com.au
 ACN 604 671 374
 Queensland Surveying Pty Ltd, a Veris Company

Drawing No 30105-LP22 Issue F

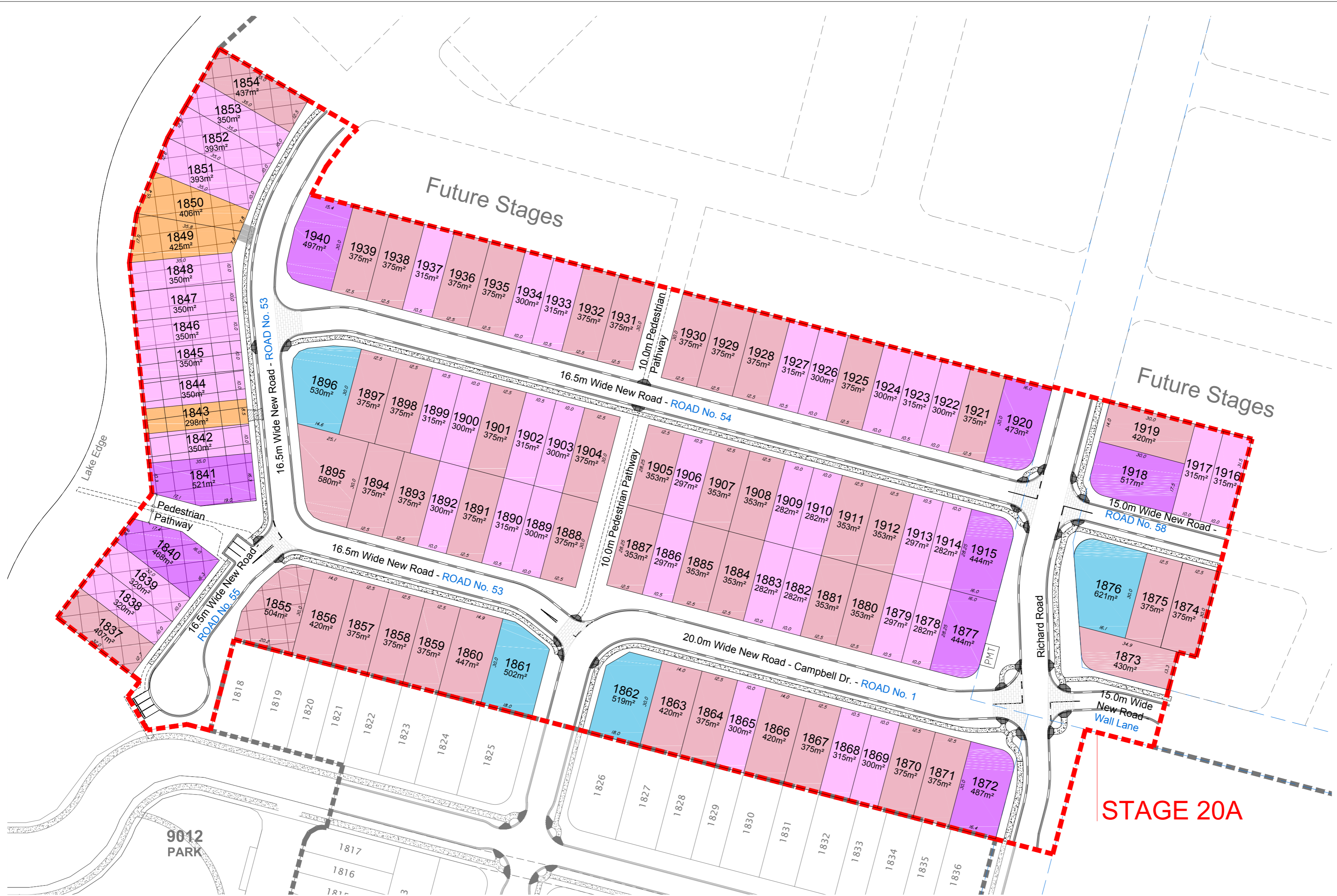

Legend

Stage Boundary	
Mandatory Shared Driveways Locations	
Driveway design must be in accordance with Council requirements.	
Driveways Locations	
Driveway design must be in accordance with Council requirements.	
Mandatory 2 Storey Detached Product for Lots 1837-1854 & 1855	
Existing Lot boundary	
Pathway	

Yield Summary

Front Loaded Product	Count	Percentage
Lots 10.0m-12.49m	41	39.4%
Lots 12.5m-14.99m	48	46.2%
Lots 15.0m-17.99m	8	7.7%
Lots 18.0m-21.99	4	3.8%
Lots 22.0m+	0	0%
TOTAL NUMBER OF LOTS	104	100%

Development Summary

Total Stage Area	5.8833ha
Total Number of Lots	104
Total Area of Lots	3.8572ha
Approx. Area of New Road / Pathways	2.0261ha
Approx. Length of New Road	1000m

Notes:
 Please refer to the following plans for additional information:

Setbacks & Requirements	GP50-D & BLE25-D Excluding lots 1843, 1849 & 1850 BLE25-D (Sheet 1&2) For lots 1843, 1849 & 1850	Veris Suite Veris Suite
-------------------------	---	----------------------------