

- LEGEND**
- New Hydrant
  - New Isolation Valve
  - New End Cap
  - New Scour Valve
  - New Taper
  - New Water Service Conduit (Ø100 uPVC PN9)
  - New Water Meter
  - New Water House connection

**REGISTERED SURVEYOR'S CERTIFICATION**  
 We, Queensland Surveying Pty Ltd (ACN 604 671 374) Cadastral Surveyors, hereby certify that the vertical and horizontal locations and dimensions shown on this plan are a true and correct record and were located by survey.  
 Delegate (signature) *[Signature]* 6152 16/11/2017  
 Registration ID Date

**ENGINEER'S CERTIFICATION**  
 I, DARRYL HAYTER, being a Consulting Engineer and duly authorised representative of: EMPOWER ENGINEERS AND PROJECT MANAGERS hereby:-  
 # certify the information contained in this drawing is an accurate "as constructed" representation of the works;  
 # accept responsibility for the "as constructed" information contained in this drawing; and  
 # acknowledge the "as constructed" information contained in the drawing may be relied on by the Moreton Bay Regional Council and others.  
 Certification for Stage 19 by *[Signature]* on 24/11/17  
 For: EMPOWER ENGINEERS AND PROJECT MANAGERS RPEQ 5694

<b>A1</b>	C	16/11/2017	UPDATE	EJM	EJM
	B	10/11/2017	UPDATE	EJM	EJM
	A	1/9/2017	PROGRESS PLOT	EJM	EJM
	INDEX	DATE	REVISIONS	DRAWN	CHECKED

DRAWN	EJM	10/11/2017
CHECKED	EJM	10/11/2017
PASSED	-	-
INITIALS		DATE

**veris**  
 BRISBANE 071 4981 4700  
 MACKAY 071 4981 2811  
 PROSERPINE 071 4948 1722  
 CAIRNS 071 4981 6722  
 veris.com.au  
 ACN: 604 671 374  
 Queensland Surveying Pty Ltd, a Veris Company



**Unitywater**  
 AS-CONSTRUCTED  
 WATER  
 STAGE 19, CAPESTONE

SCALE	1:500
SHEET	1 OF 2 SHEETS
DRAWING NO.	30105-190100-AW01

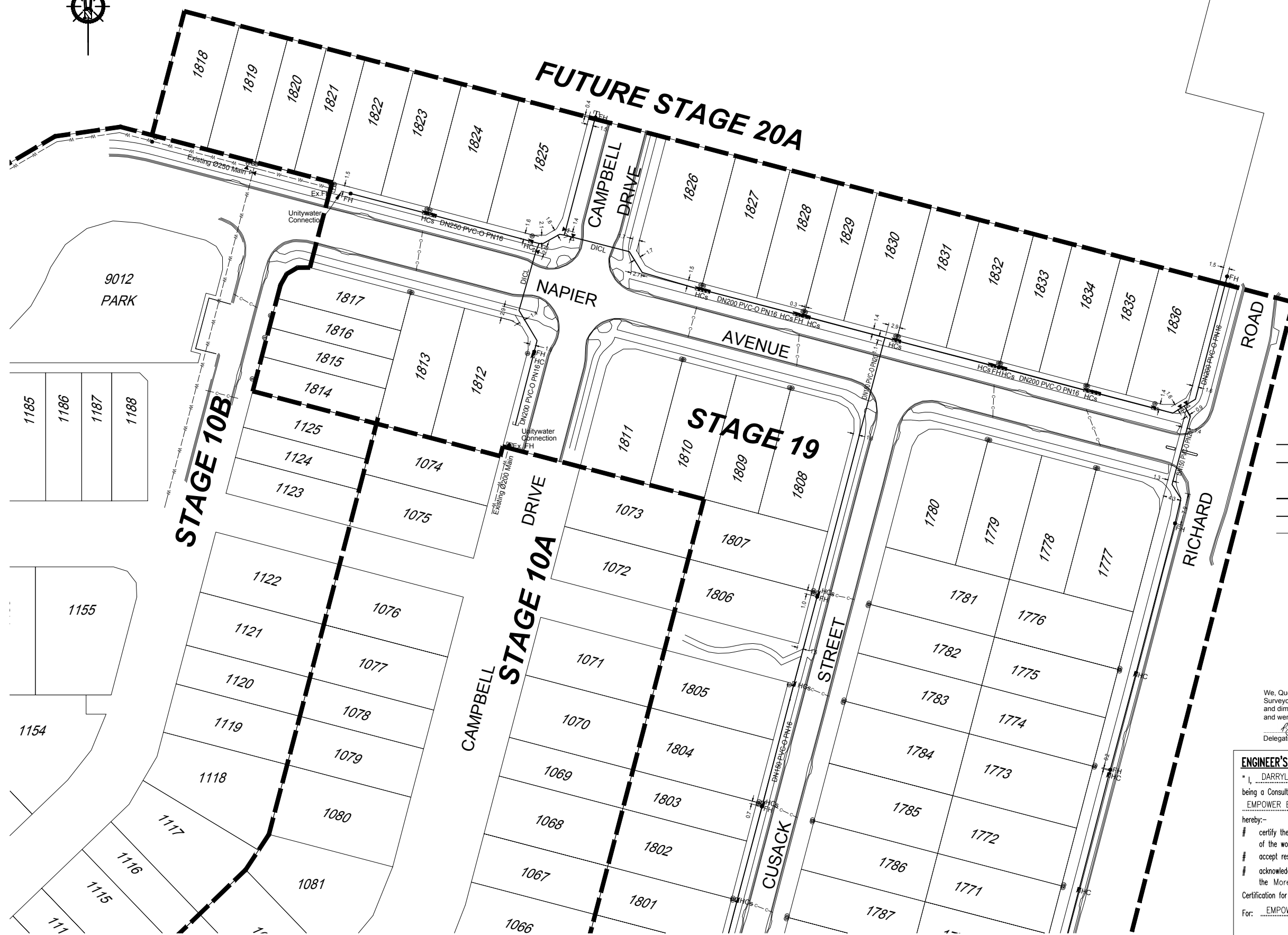

○ PM55164

- LEGEND**
- New Hydrant
  - New Isolation Valve
  - New End Cap
  - New Scour Valve
  - New Taper
  - New Water Service Conduit (Ø100 uPVC PN9)
  - New Water Meter
  - New Water House connection

**REGISTERED SURVEYOR'S CERTIFICATION**

We, Queensland Surveying Pty Ltd (ACN 604 671 374) Cadastral Surveyors, hereby certify that the vertical and horizontal locations and dimensions shown on this plan are a true and correct record and were located by survey.

Delegate (signature) *[Signature]* 6152 16/11/2017  
 Registration ID Date

**ENGINEER'S CERTIFICATION**

\* I, DARRYL HAYTER  
 being a Consulting Engineer and duly authorised representative of: -  
EMPOWER ENGINEERS AND PROJECT MANAGERS  
 hereby:-  
 # certify the information contained in this drawing is an accurate "as constructed" representation of the works;  
 # accept responsibility for the "as constructed" information contained in this drawing; and  
 # acknowledge the "as constructed" information contained in the drawing may be relied on by the Moreton Bay Regional Council and others.  
 Certification for Stage 19 by D. Hayter on 24/11/17  
 For: EMPOWER ENGINEERS AND PROJECT MANAGERS RPEQ 5694

<b>A1</b>	C	16/11/2017	UPDATE	EJM	EJM
	B	2/11/2017	UPDATE	EJM	EJM
	A	1/9/2017	PROGRESS PLOT	EJM	EJM
	INDEX	DATE	REVISIONS	DRAWN	CHECKED

DRAWN	EJM	16/11/2017
CHECKED	EJM	16/11/2017
PASSED	-	-
INITIALS		DATE

BRISBANE 071 488 4700  
 MACKAY 071 488 1811  
 PROSERPINE 071 488 1722  
 CAIRNS 071 488 1722

veris.com.au  
 ACN 604 671 374  
 Queensland Surveying Pty Ltd, a Veris Company



**Unitywater**

AS-CONSTRUCTED WATER  
 STAGE 19, CAPESTONE

SCALE	1:500
SHEET	2 OF 2 SHEETS
DRAWING NO.	30105-190100-AW01
	C B A