

I, Peter Sippel, being a cadastral surveyor and duly authorised representative of Queensland Surveying Pty Ltd hereby:

- certify the information contained in this drawing is an accurate as constructed representation of the works
- accept responsibility for the as constructed information contained in this drawing
- acknowledge the as constructed information contained in the drawing may be relied on by council and others

Certification by *P.Sippel* on 16/11/2017
(Signature) (Date)
for Queensland Surveying Pty Ltd

ENGINEER'S CERTIFICATION

I, DARRYL HAYTER, being a Consulting Engineer and duly authorised representative of: EMPOWER ENGINEERS AND PROJECT MANAGERS hereby:

- certify the information contained in this drawing is an accurate "as constructed" representation of the works;
- accept responsibility for the "as constructed" information contained in this drawing; and
- acknowledge the "as constructed" information contained in the drawing may be relied on by the Moreton Bay Regional Council and others.

Certification for Stage 19 by *D. Hayter* on 24/11/17
For: EMPOWER ENGINEERS AND PROJECT MANAGERS RPEQ 5694

DRAWING REVISIONS		REFERENCE DRAWINGS		DESIGN FILE No.		DESIGNED	
REV.	REVISION DESCRIPTION	DRG. No.	DESCRIPTION	CONSTRUCT. No.	DATE	DATE	
A	Progress Plot			SURVEY FILE No. 30105-190100 AD			EJM
B	Update			FIELD BOOK		16/11/2017	
C	Update			LOG BOOK			EJM
D	Update			LEVEL DATUM	AHD	16/11/2017	
				DATUM	PM177891		

THIS WORK WAS PREPARED BY:
QUEENSLAND SURVEYING PTY LTD

SCALE 1:500 ORIGINAL SIZE A1



MORETON BAY REGIONAL COUNCIL
CABOOLTURE DISTRICT OFFICE
2 HASKING STREET CABOOLTURE QLD 4510
PO BOX 159 CABOOLTURE QLD 4510
Telephone: (07) 5433 0100
Fax: (07) 5433 4000

STAGE 19, CAPESTONE AS CONSTRUCTED DRAINAGE

MBRC SUBDIVISION REFERENCE	
DA/32670/2016/V23R	
No. 1 OF 2 PLANS	
DRAWING NUMBER	REV.
30105-190100 AD	D



I, Peter Sippel, being a cadastral surveyor and duly authorised representative of Queensland Surveying Pty Ltd hereby:

- certify the information contained in this drawing is an accurate as constructed representation of the works
- accept responsibility for the as constructed information contained in this drawing
- acknowledge the as constructed information contained in the drawing may be relied on by council and others

Certification by *Peter Sippel* on 16/11/2017
 (Signature) (Date)
 for Queensland Surveying Pty Ltd

○ PM55164

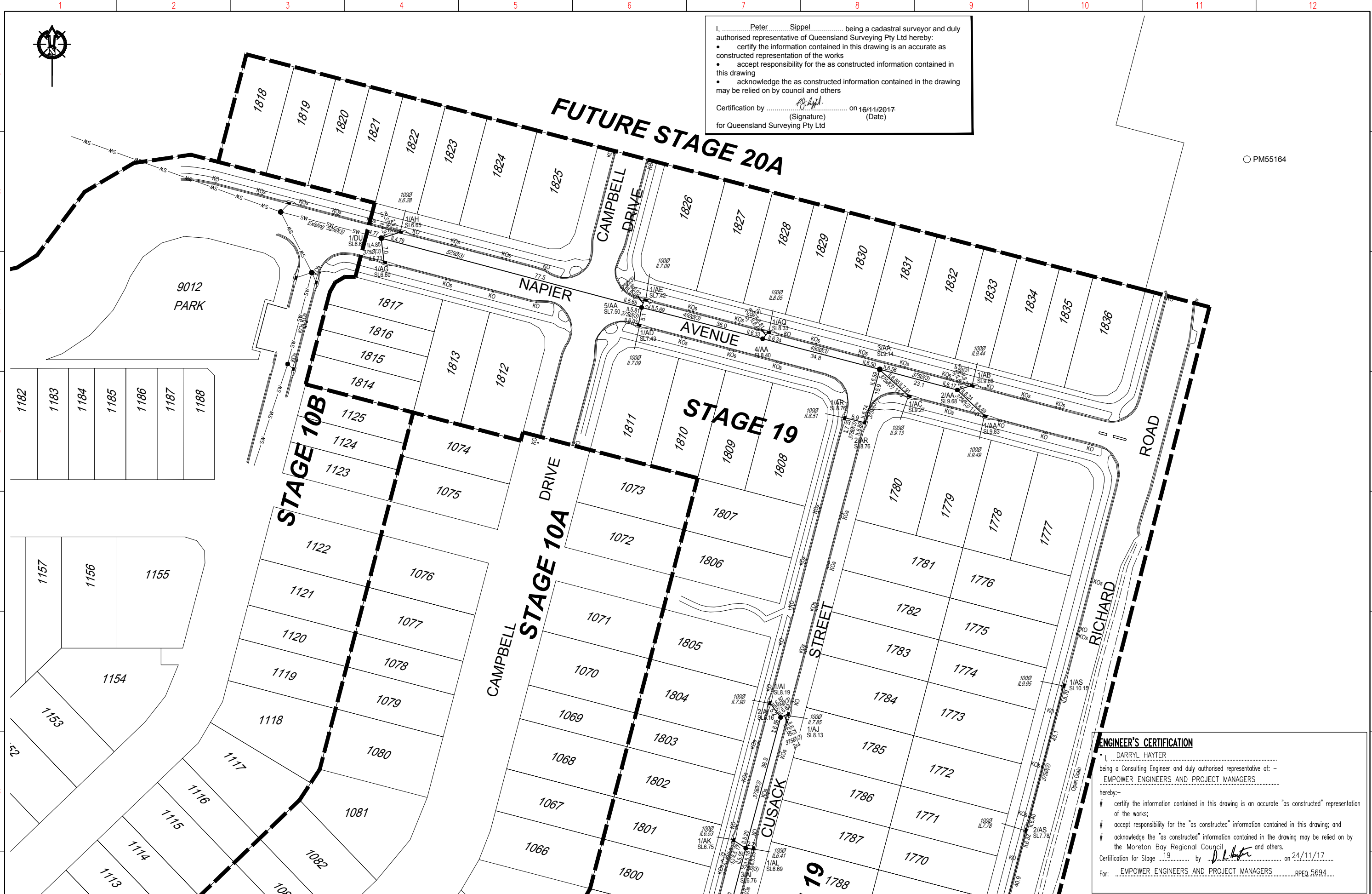

ENGINEER'S CERTIFICATION

I, DARRYL HAYTER, being a Consulting Engineer and duly authorised representative of: - EMPOWER ENGINEERS AND PROJECT MANAGERS hereby:

- certify the information contained in this drawing is an accurate "as constructed" representation of the works;
- accept responsibility for the "as constructed" information contained in this drawing; and
- acknowledge the "as constructed" information contained in the drawing may be relied on by the Moreton Bay Regional Council and others.

Certification for Stage 19 by *D. Hayter* on 24/11/17
 For: EMPOWER ENGINEERS AND PROJECT MANAGERS RPEQ 5694

DRAWING REVISIONS		REFERENCE DRAWINGS		DESIGN FILE No.	DESIGNED
REV.	REVISION DESCRIPTION	DRG. No.	DESCRIPTION	CONSTRUCT. No.	DATE
A	Progress Plot			SURVEY FILE No. 30105-190100 AD	DRAWN EJM
B	Update			FIELD BOOK	DATE 16/11/2017
C	Update			LOG BOOK	CHECKED EJM
D	Update			LEVEL DATUM AHD	DATE 16/11/2017
				DATUM PM177891	

THIS WORK WAS PREPARED BY:
QUEENSLAND SURVEYING PTY LTD

SCALE 1:500 ORIGINAL SIZE A1

MORETON BAY REGIONAL COUNCIL
 CABOOLTURE DISTRICT OFFICE
 2 HASKING STREET CABOOLTURE QLD 4510
 PO BOX 159 CABOOLTURE QLD 4510
 Telephone: (07) 5433 0100
 Fax: (07) 5433 4000

STAGE 19, CAPESTONE AS CONSTRUCTED DRAINAGE

MBRC SUBDIVISION REFERENCE	
DA/32670/2016/V23R	
No. 2 OF 2 PLANS	
DRAWING NUMBER	REV.
30105-190100 AD	D