

**ENGINEER'S CERTIFICATION**

I, DARRYL HAYTER  
 being a Consulting Engineer and duly authorised representative of: -  
 EMPOWER ENGINEERS AND PROJECT MANAGERS  
 hereby:-  
 # certify the information contained in this drawing is an accurate "as constructed" representation of the works;  
 # accept responsibility for the "as constructed" information contained in this drawing; and  
 # acknowledge the "as constructed" information contained in the drawing may be relied on by the MORETON BAY REGIONAL COUNCIL and others.  
 Certification for Stage 21A by D. Hayter on 31/03/21  
 For: EMPOWER ENGINEERS AND PROJECT MANAGERS RPEQ 5694

**REGISTERED SURVEYOR'S CERTIFICATION**

We, VERIS AUSTRALIA PTY LTD, hereby certify that the vertical and horizontal locations and dimensions shown on this plan are a true and correct record and were located by survey.  
Alistair Byrom  
 Delegate Cadastral Surveyor (sig.) Reg. Surveyor No. 6448 Date: 30/03/2021

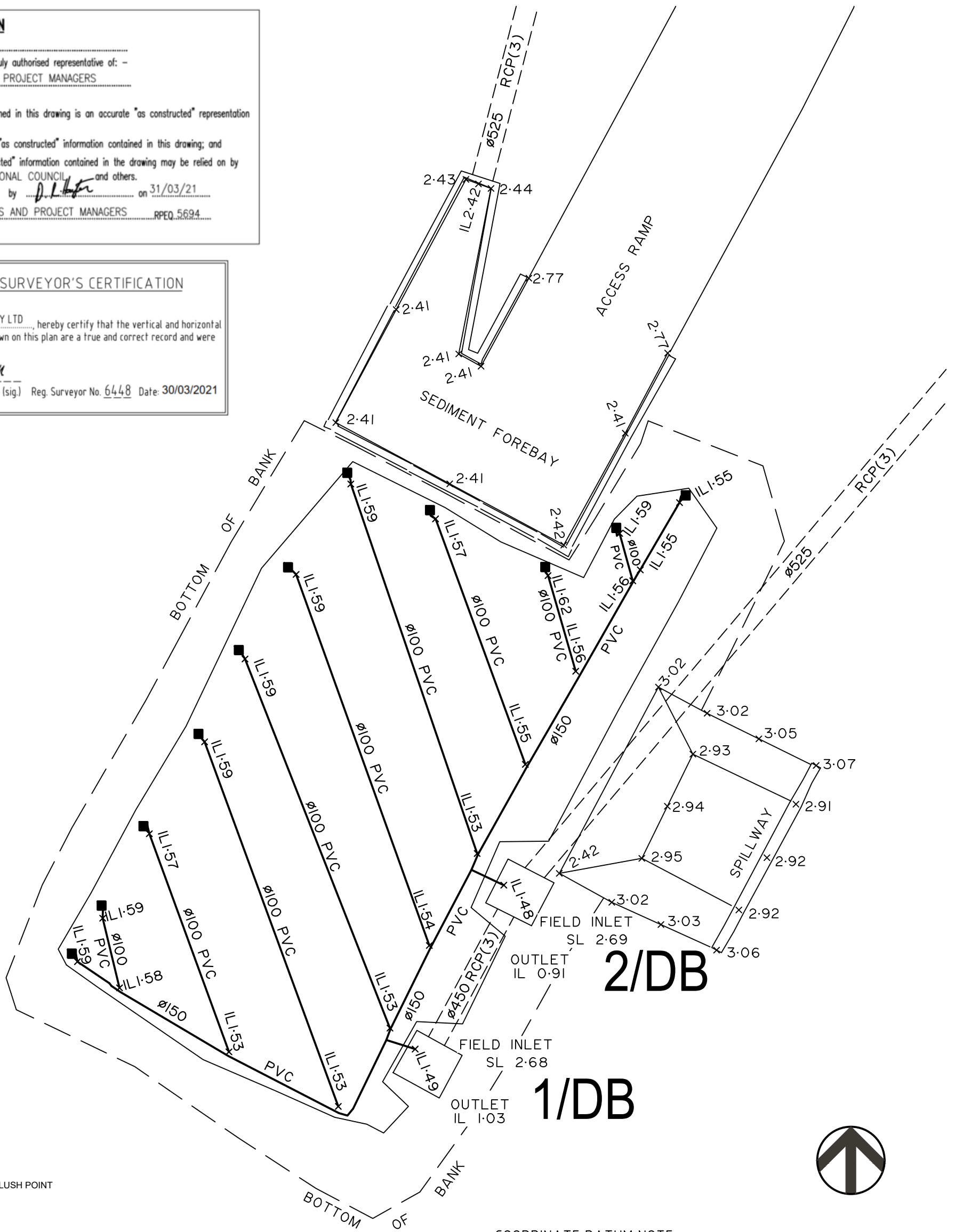

■ BASIN PIPE FLUSH POINT



**COORDINATE DATUM NOTE:**

HORIZONTAL COORDINATES(E,N) SUPPLIED ARE MAPPING GRID OF AUSTRALIA(MGA), ZONE 56 BASED ON THE UNIVERSAL TRANSVERSE MERCATOR PROJECTION AND THE GEOCENTRIC DATUM OF AUSTRALIA 1994.  
 HORIZONTAL DATUM DERIVED FROM PSM186710, E 503315.600, N 6987236.028.  
 LEVELS SUPPLIED ARE ON THE AUSTRALIAN HEIGHT DATUM(AHD)  
 LEVEL DATUM DERIVED FROM PSM177891 RL 16.396 (AHD)

0 5m 10m 15m 50mm 100mm 150mm SCALE BAR

THESE DESIGNS AND DRAWINGS ARE COPYRIGHT AND ARE NOT TO BE USED OR REPRODUCED WITHOUT THE WRITTEN PERMISSION OF VERIS

**IMPORTANT NOTES:**

(These notes are an integral part of this plan)  
 This plan has been prepared for Mango Boulevard Unit trust for the purposes of showing As Constructed Filter Pipes and Final Surface and Sub-Surface Levels in Bio-Retention Basin. It is not to be used by any other person or corporation or for any other purposes.

Copyright © Veris Australia Pty Ltd.  
 02/03/2021

<b>Data Sources</b>	30105-21-LC - Rev E
Cadastral Boundaries	
Contours / Topographic	
Engineering Design	EMPOWER
Locality:	MANGO HILL
Local Authority:	MORTON BAY REGIONAL
Horizontal Meridian:	MGA56
Vertical Level Datum:	AHD
Level Origin:	PSM177891 RL 16.396
Scale:	1:100 @ A3
Surveyed:	LS
Designed:	EMPOWER
Drawn:	JMc
Checked:	*

**As Constructed Bio-Retention Basin E1 Filter Pipes, Invert Levels and Sediment Forebay and Spillway FSL.**

Plot Date: 10 Mar, 2021  
 Computer File Ref: 430105-21A-BIO-E1 (A).dwg

**STAGE 21A CAPESTONE ESTATE**  
**CAPESTONE BLDE MANGO HILL**  
 for  
**Mango Boulevard Unit Trust**



BRISBANE (07) 3666 4700 WHITSUNDAYS (07) 4945 6600  
 MACKAY (07) 49579700 CAIRNS (07) 4652 9400

veris.com.au  
 ACN 615 735 727  
 Veris Australia Pty Ltd

Drawing No 430105-21A-BIO-E1 Issue A

SHEET 1 OF 2



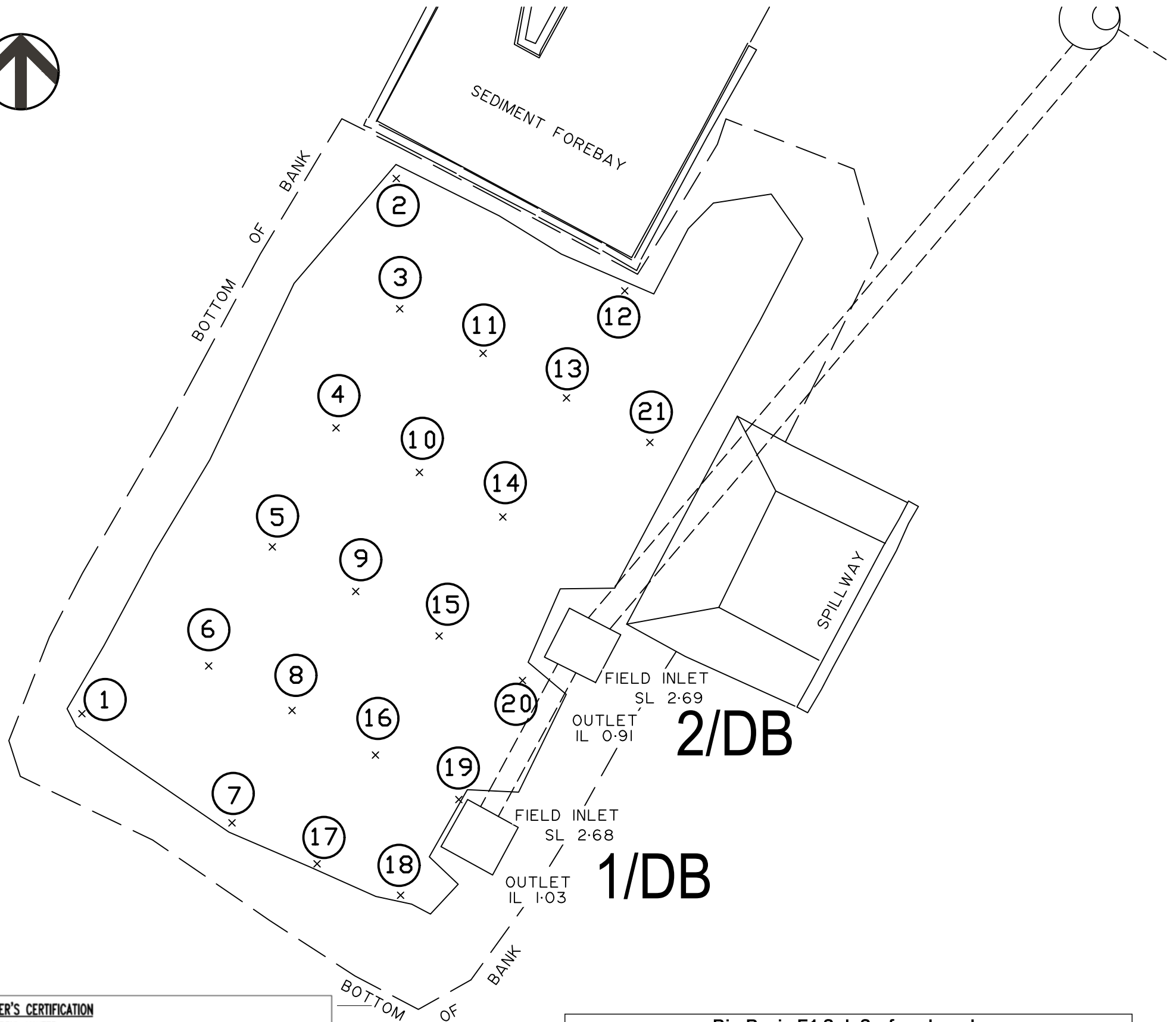

**ENGINEER'S CERTIFICATION**  
 I, DARRYL HAYTER  
 being a Consulting Engineer and duly authorised representative of: -  
 EMPOWER ENGINEERS AND PROJECT MANAGERS  
 hereby:-  
 # certify the information contained in this drawing is an accurate "as constructed" representation of the works;  
 # accept responsibility for the "as constructed" information contained in this drawing; and  
 # acknowledge the "as constructed" information contained in the drawing may be relied on by the MORETON BAY REGIONAL COUNCIL and others.  
 Certification for Stage 21A by *D. Hayter* on 31/03/21  
 For: EMPOWER ENGINEERS AND PROJECT MANAGERS RPEQ 5694

**REGISTERED SURVEYOR'S CERTIFICATION**  
 We, VERIS AUSTRALIA PTY LTD, hereby certify that the vertical and horizontal locations and dimensions shown on this plan are a true and correct record and were located by survey.  
*Alastair Byrom*  
 Delegate Cadastral Surveyor (sig) Reg. Surveyor No. 6448 Date: 30/03/2021

Bio-Basin E1 Sub Surface Levels					
Point	Base RL (m)	Gravel RL(m)	Depth (m)	Loam RL(m)	Depth (m)
1	1.589	1.904	0.315	2.393	0.489
2	1.517	1.876	0.359	2.401	0.525
3	1.475	1.899	0.424	2.4	0.501
4	1.501	1.902	0.401	2.383	0.481
5	1.479	1.902	0.423	2.362	0.46
6	1.482	1.907	0.425	2.38	0.473
7	1.512	1.899	0.387	2.381	0.482
8	1.468	1.903	0.435	2.405	0.502
9	1.482	1.9	0.418	2.38	0.48
10	1.484	1.902	0.418	2.369	0.467
11	1.489	1.904	0.415	2.398	0.494
12	1.508	1.889	0.381	2.392	0.503
13	1.486	1.899	0.413	2.404	0.505
14	1.477	1.901	0.424	2.395	0.494
15	1.471	1.909	0.438	2.39	0.481
16	1.468	1.89	0.422	2.383	0.493
17	1.465	1.896	0.431	2.38	0.484
18	1.497	1.886	0.389	2.403	0.517
19	1.466	1.889	0.423	2.384	0.495
20	1.475	1.893	0.418	2.384	0.491
21	1.491	1.897	0.406	2.416	0.519

**COORDINATE DATUM NOTE:**  
 HORIZONTAL COORDINATES(E,N) SUPPLIED ARE MAPPING GRID OF AUSTRALIA(MGA), ZONE 56 BASED ON THE UNIVERSAL TRANSVERSE MERCATOR PROJECTION AND THE GEOCENTRIC DATUM OF AUSTRALIA 1994.  
 HORIZONTAL DATUM DERIVED FROM PSM186710, E 503315.600, N 6987236.028.  
 LEVELS SUPPLIED ARE ON THE AUSTRALIAN HEIGHT DATUM(AHD)  
 LEVEL DATUM DERIVED FROM PSM177891 RL 16.396 (AHD)



**IMPORTANT NOTES:**  
 (These notes are an integral part of this plan)  
 This plan has been prepared for Mango Boulevard Unit trust for the purposes of showing As Constructed Filter Pipes and Final Surface and Sub-Surface Levels in Bio-Retention Basin. It is not to be used by any other person or corporation or for any other purposes.  
 Copyright © Veris Australia Pty Ltd.  
 [02/03/2021]

<b>Data Sources</b>	30105-21-LC - Rev E
Cadastral Boundaries	
Contours / Topographic	
Engineering Design	EMPOWER
Locality:	MANGO HILL
Local Authority:	MORTON BAY REGIONAL
Horizontal Meridian:	MGA56
Vertical Level Datum:	AHD
Level Origin:	PSM177891 RL 16.396
Scale:	1:100 @ A3
Surveyed:	LS
Designed:	EMPOWER
Drawn:	JMc
Checked:	*

**As Constructed Bio-Retention Basin E1 Sub-Surface Levels (See Table)**

Plot Date: 10 Mar, 2021  
 Computer File Ref: 430105-21A-BIO-E1 (A).dwg

**STAGE 21A CAPESTONE ESTATE**  
**CAPESTONE BLDE MANGO HILL**  
 for  
**Mango Boulevard Unit Trust**

SHEET 2 OF 2

BRISBANE (07) 3666 4700 WHITSUNDAYS (07) 4945 6600  
 MACKAY (07) 49579700 CAIRNS (07) 4652 9400  
 veris.com.au  
 ACN 615 735 727  
 Veris Australia Pty Ltd

Drawing No: 430105-21A-BIO-E1 Issue: A

