

COORDINATE DATUM NOTE:
 HORIZONTAL COORDINATES(E,N) SUPPLIED ARE MAPPING GRID OF AUSTRALIA(MGA), ZONE 56 BASED ON THE UNIVERSAL TRANSVERSE MERCATOR PROJECTION AND THE GEOCENTRIC DATUM OF AUSTRALIA 1994.
 HORIZONTAL DATUM DERIVED FROM PSM186710, E 503315.600, N 6987236.028.
 LEVELS SUPPLIED ARE ON THE AUSTRALIAN HEIGHT DATUM(AHD)
 LEVEL DATUM DERIVED FROM PSM177891 RL 16.396 (AHD)

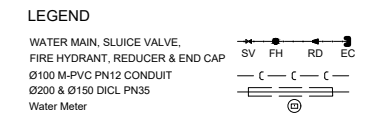
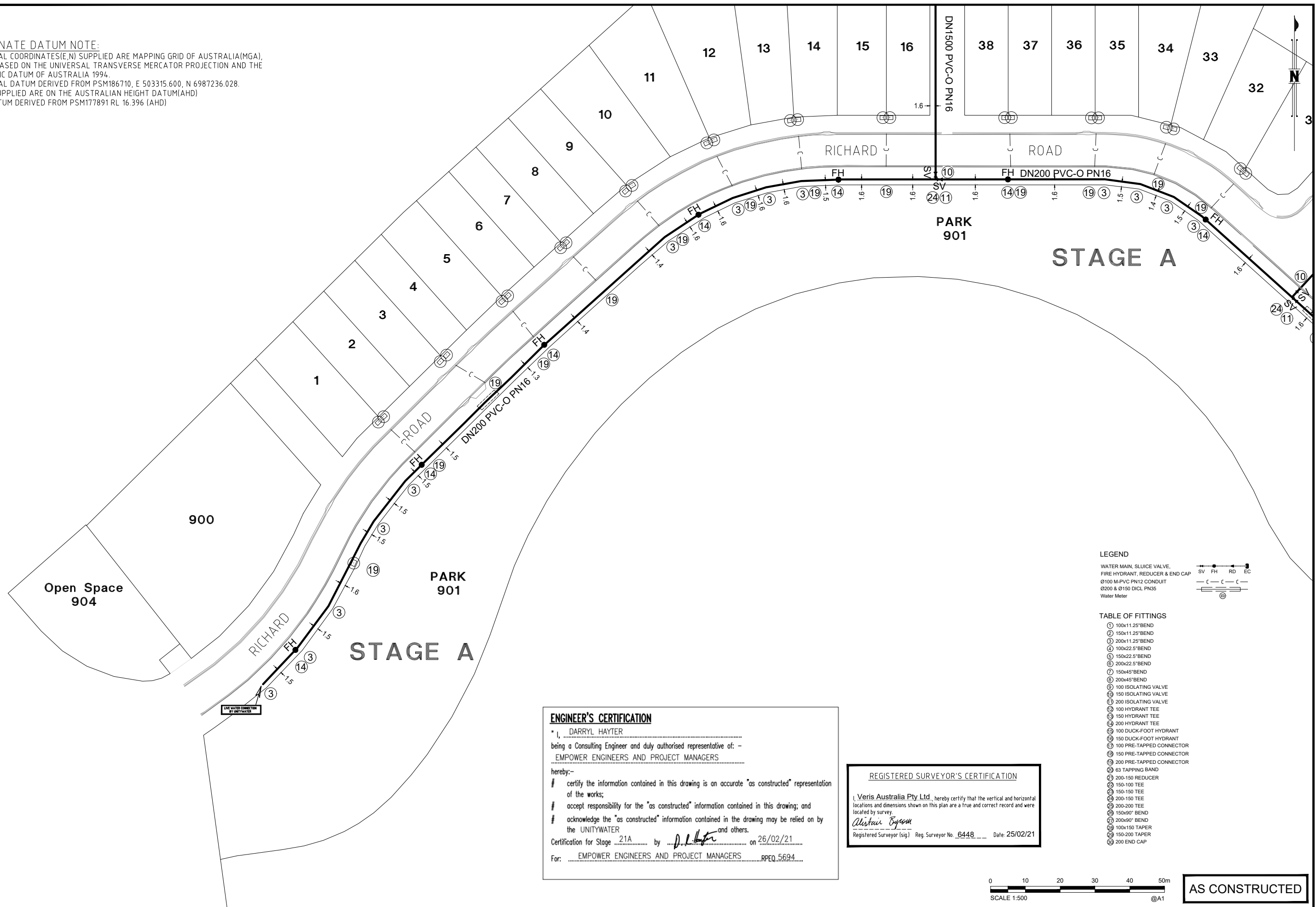

- TABLE OF FITTINGS**
- ① 100x11.25° BEND
 - ② 150x11.25° BEND
 - ③ 200x11.25° BEND
 - ④ 100x22.5° BEND
 - ⑤ 150x22.5° BEND
 - ⑥ 200x22.5° BEND
 - ⑦ 150x45° BEND
 - ⑧ 200x45° BEND
 - ⑨ 100 ISOLATING VALVE
 - ⑩ 150 ISOLATING VALVE
 - ⑪ 200 ISOLATING VALVE
 - ⑫ 100 HYDRANT TEE
 - ⑬ 150 HYDRANT TEE
 - ⑭ 200 HYDRANT TEE
 - ⑮ 100 DUCK-FOOT HYDRANT
 - ⑯ 150 DUCK-FOOT HYDRANT
 - ⑰ 100 PRE-TAPPED CONNECTOR
 - ⑱ 150 PRE-TAPPED CONNECTOR
 - ⑲ 200 PRE-TAPPED CONNECTOR
 - ⑳ 63 TAPPING BAND
 - ㉑ 200-150 REDUCER
 - ㉒ 150-100 TEE
 - ㉓ 150-150 TEE
 - ㉔ 200-150 TEE
 - ㉕ 200-200 TEE
 - ㉖ 150x90° BEND
 - ㉗ 200x90° BEND
 - ㉘ 100x150 TAPER
 - ㉙ 150-200 TAPER
 - ㉚ 200 END CAP

ENGINEER'S CERTIFICATION

I, DARRYL HAYTER
 being a Consulting Engineer and duly authorised representative of: -
EMPOWER ENGINEERS AND PROJECT MANAGERS
 hereby:-
 # certify the information contained in this drawing is an accurate "as constructed" representation of the works;
 # accept responsibility for the "as constructed" information contained in this drawing; and
 # acknowledge the "as constructed" information contained in the drawing may be relied on by the UNITYWATER and others.
 Certification for Stage 21A by [Signature] on 26/02/21
 For: EMPOWER ENGINEERS AND PROJECT MANAGERS RPEQ 5,694

REGISTERED SURVEYOR'S CERTIFICATION

I, Veris Australia Pty Ltd, hereby certify that the vertical and horizontal locations and dimensions shown on this plan are a true and correct record and were located by survey.
[Signature]
 Registered Surveyor (sig) Reg. Surveyor No. 6448 Date: 25/02/21

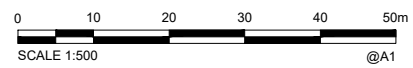

AS CONSTRUCTED

A1	INDEX	DATE	REVISIONS	DRAWN	CHECKED	PASSED	INITIALS	DATE
	A	25/02/2021	ORIGINAL	JMc	JMc			

	BRISBANE (07) 3888 4700 MACKAY (07) 4602 9700 WHITSUNDAYS (07) 4645 0800 CAIRNS (07) 4032 3400 VERIS.COM.AU ACN 610 756 727 Veris Australia Pty Ltd
--	---



Unitywater
 2019015600S1
 Capestone Stage 21A
 Capestone Boulevard, Mango Hill.
 As Constructed Water

SHEET 1 OF 2 SHEETS	SCALE 1:500 @A1
REVISION DATE 25/02/2021	REVISION A
DISCIPLINE CODE C	
DRAWING NO. U-2020-3215 W	

COORDINATE DATUM NOTE:

HORIZONTAL COORDINATES(E,N) SUPPLIED ARE MAPPING GRID OF AUSTRALIA(MGA), ZONE 56 BASED ON THE UNIVERSAL TRANSVERSE MERCATOR PROJECTION AND THE GEOCENTRIC DATUM OF AUSTRALIA 1994.
 HORIZONTAL DATUM DERIVED FROM PSM186710, E 503315.600, N 6987236.028.
 LEVELS SUPPLIED ARE ON THE AUSTRALIAN HEIGHT DATUM(AHD)
 LEVEL DATUM DERIVED FROM PSM177891 RL 16.396 (AHD)

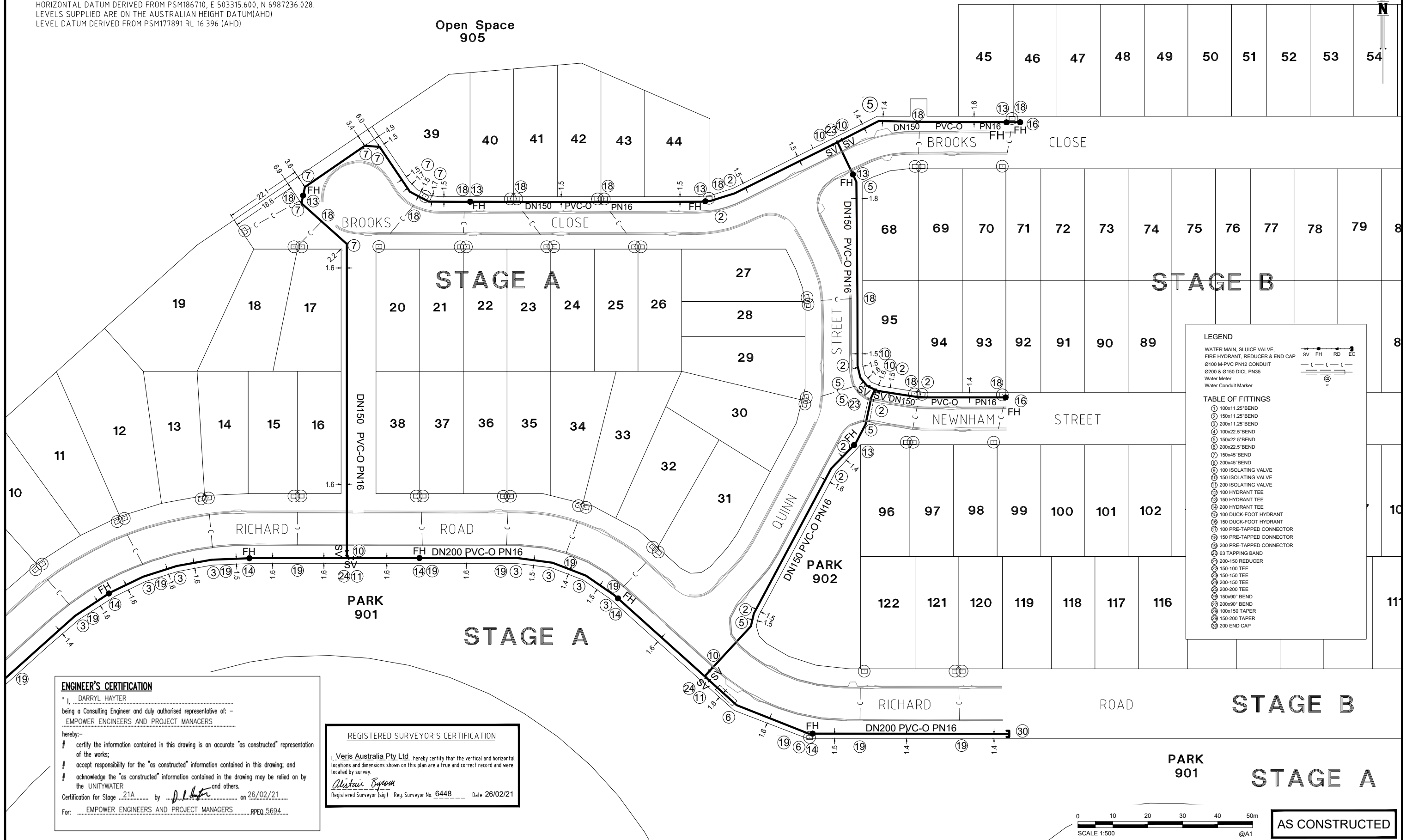

ENGINEER'S CERTIFICATION
 I, DARRYL HAYTER
 being a Consulting Engineer and duly authorised representative of: -
EMPOWER ENGINEERS AND PROJECT MANAGERS
 hereby:-
 # certify the information contained in this drawing is an accurate "as constructed" representation of the works;
 # accept responsibility for the "as constructed" information contained in this drawing; and
 # acknowledge the "as constructed" information contained in the drawing may be relied on by the UNITYWATER and others.
 Certification for Stage 21A by D.H. on 26/02/21
 For: EMPOWER ENGINEERS AND PROJECT MANAGERS RPEQ 5694

REGISTERED SURVEYOR'S CERTIFICATION
Veris Australia Pty Ltd hereby certify that the vertical and horizontal locations and dimensions shown on this plan are a true and correct record and were located by survey.
Alister Symon
 Registered Surveyor (sig) Reg. Surveyor No. 6448 Date 26/02/21

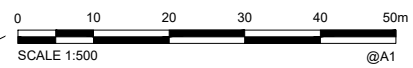

AS CONSTRUCTED

A1																					
	A	25/02/2021	ORIGINAL		JMc	JMc															
	INDEX	DATE		REVISIONS	DRAWN	CHECKED	PASSED			INITIALS		DATE									



BRISBANE (07) 3886 4700
 WHITSUNDAYS (07) 4661 8888
 MACKAY (07) 4567 9700
 CAIRNS (07) 4532 5400
 veris.com.au
 ACN 615 735 727
 Veris Australia Pty Ltd



Unitywater
 2019015600S1
 Capestone Stage 21A
 Capestone Boulevard, Mango Hill.
 As Constructed Water

SHEET 2 OF 2 SHEETS	SCALE 1:500 @ A1
REVISION DATE 25/02/2021	REVISION A
DISCIPLINE CODE C	
DRAWING NO. U-2020-3215 W	