

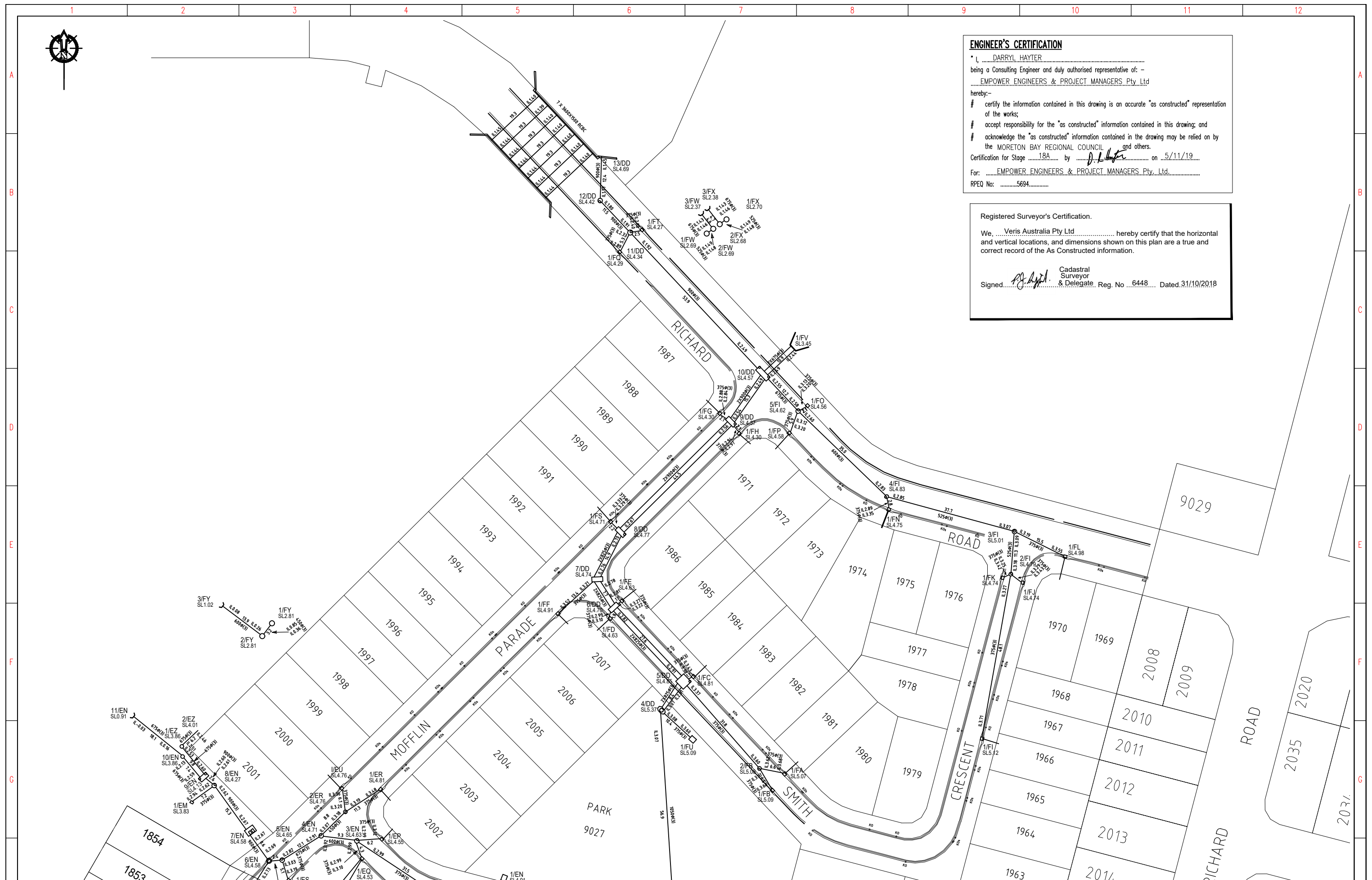

ENGINEER'S CERTIFICATION
 I, DARRYL HAYTER
 being a Consulting Engineer and duly authorised representative of: -
EMPOWER ENGINEERS & PROJECT MANAGERS Pty Ltd
 hereby:-
 # certify the information contained in this drawing is an accurate "as constructed" representation of the works;
 # accept responsibility for the "as constructed" information contained in this drawing; and
 # acknowledge the "as constructed" information contained in the drawing may be relied on by the MORETON BAY REGIONAL COUNCIL and others.
 Certification for Stage 18A by D. Hayter on 5/11/19
 For: EMPOWER ENGINEERS & PROJECT MANAGERS Pty Ltd
 RPEQ No: 5694

Registered Surveyor's Certification.
 We, Veris Australia Pty Ltd hereby certify that the horizontal and vertical locations, and dimensions shown on this plan are a true and correct record of the As Constructed information.
 Signed: [Signature] Cadastral Surveyor & Delegate, Reg. No 6448 Dated 31/10/2018



REV.	DRAWING REVISIONS	REFERENCE DRAWINGS	DESIGN FILE No.	DESIGNED
A	Progress Plot		CONSTRUCT. No.	DATE
			SURVEY FILE No. 30105-18A100 AD	DRAWN JMc
			FIELD BOOK	DATE 27/08/2019
			LOG BOOK	CHECKED JMc
			LEVEL DATUM	DATE 27/08/2019
			DATUM	AHD PM177891

veris
 BRISBANE 671 3881 4700
 MACKAY 671 4011 2011
 WHITSLUNDAYS 071 4645 1722
 CAIRNS 071 4011 6722
 veris.com.au
 ACN 619 750 727
 Veris Australia Pty Ltd

Moreton Bay
 Regional Council

SCALE 1:500 ORIGINAL SIZE A1

MORETON BAY REGIONAL COUNCIL
 CABOOLTURE DISTRICT OFFICE
 2 HASKING STREET CABOOLTURE QLD 4510
 Telephone: (07) 5433 0100
 Fax: (07) 5433 4000

STAGE 18A, CAPESTONE AS CONSTRUCTED DRAINAGE

MBRC SUBDIVISION REFERENCE	
DA/36647/2018/V23R	
No. 1 OF 2 PLANS	
DRAWING NUMBER	REV.
30105-18A100 AD	A



ENGINEER'S CERTIFICATION

"I, DARRYL HAYTER
 being a Consulting Engineer and duly authorised representative of: -
EMPOWER ENGINEERS & PROJECT MANAGERS Pty. Ltd
 hereby:-
 # certify the information contained in this drawing is an accurate "as constructed" representation of the works;
 # accept responsibility for the "as constructed" information contained in this drawing; and
 # acknowledge the "as constructed" information contained in the drawing may be relied on by the MORETON BAY REGIONAL COUNCIL and others.
 Certification for Stage 18A by D. Hayter on 5/11/19
 For: EMPOWER ENGINEERS & PROJECT MANAGERS Pty. Ltd.
 RPEQ No: 5694

Registered Surveyor's Certification.

We, Veris Australia Pty Ltd hereby certify that the horizontal and vertical locations, and dimensions shown on this plan are a true and correct record of the As Constructed information.

Signed: [Signature] Cadastral Surveyor & Delegate. Reg. No. 6448 Dated: 31/10/2018

STAGE 20A

DRAWING REVISIONS REV. REVISION DESCRIPTION A Progress Plot		REFERENCE DRAWINGS DRG. No. DESCRIPTION		DESIGN FILE No. CONSTRUCT. No. SURVEY FILE No. 30105-18A100 AD FIELD BOOK LOG BOOK LEVEL DATUM DATUM		DESIGNED DATE DRAWN DATE CHECKED DATE		BRISBANE 071 986 4700 PROSERPINE 071 986 4700 MACKAY 071 461 2611 CAIRNS 071 461 0722 veris.com.au ACN 604 871 374 Queensland Surveying Pty Ltd a Veris Company		MORETON BAY REGIONAL COUNCIL CABOOLTURE DISTRICT OFFICE 2 HASKING STREET CABOOLTURE QLD 4510 PO BOX 159 CABOOLTURE QLD 4510 Telephone: (07) 5433 0100 Fax: (07) 5433 4000		STAGE 18A, CAPESTONE AS CONSTRUCTED DRAINAGE		MBRC SUBDIVISION REFERENCE DA/36647/2018/V23R No. 2 OF 2 PLANS DRAWING NUMBER REV.	
				AHD PM177891		DATE 27/08/2019 DATE 27/08/2019		SCALE 1:500 ORIGINAL SIZE A1		30105-18A100 AD		A			