

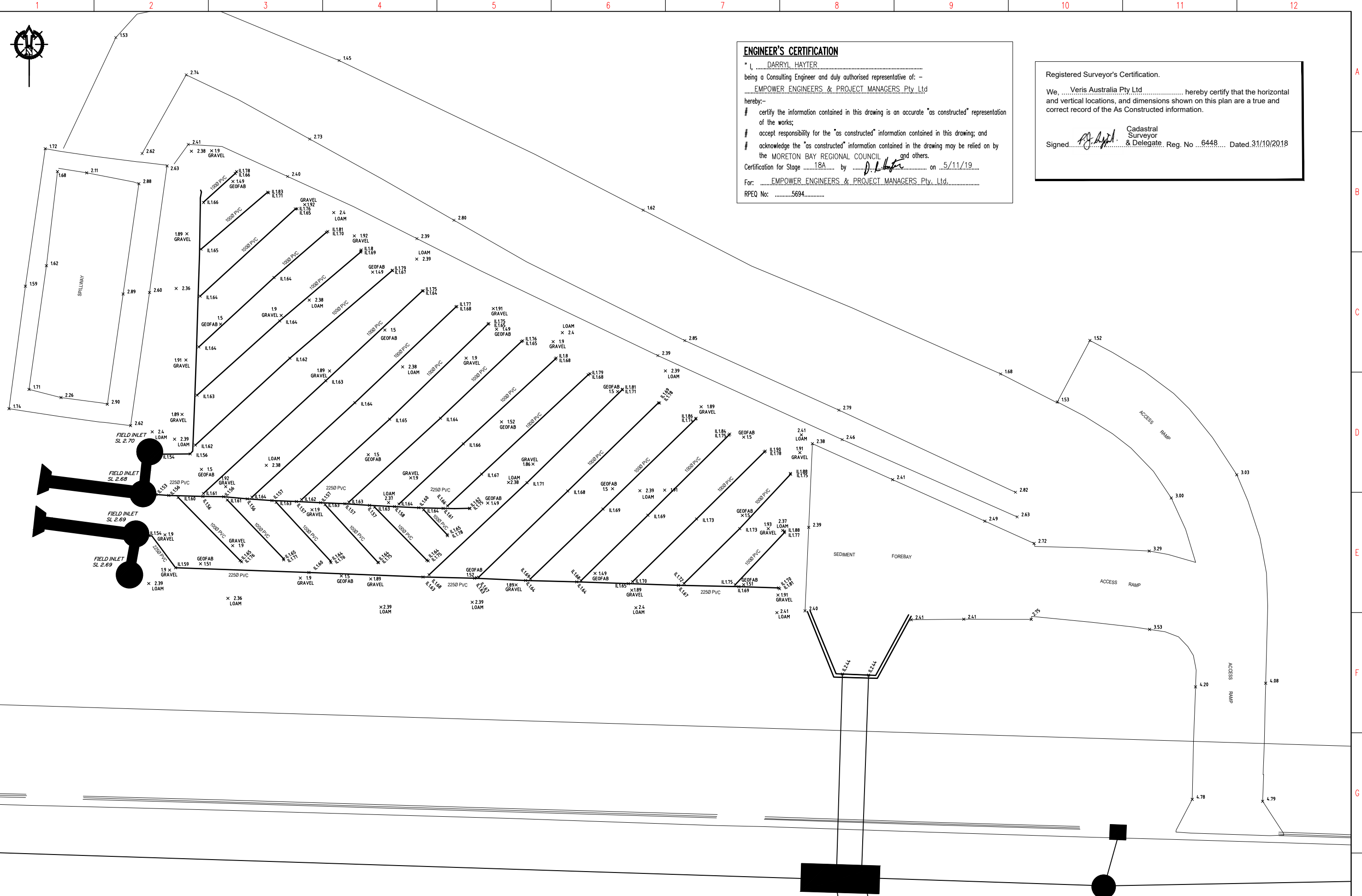

ENGINEER'S CERTIFICATION
 I, DARRYL HAYTER
 being a Consulting Engineer and duly authorised representative of: -
EMPOWER ENGINEERS & PROJECT MANAGERS Pty Ltd
 hereby:-
 # certify the information contained in this drawing is an accurate "as constructed" representation of the works;
 # accept responsibility for the "as constructed" information contained in this drawing; and
 # acknowledge the "as constructed" information contained in the drawing may be relied on by the MORETON BAY REGIONAL COUNCIL and others.
 Certification for Stage 18A by D. L. Hayter on 5/11/19
 For: EMPOWER ENGINEERS & PROJECT MANAGERS Pty. Ltd.
 RPEQ No: 5694

Registered Surveyor's Certification.
 We, Veris Australia Pty Ltd hereby certify that the horizontal and vertical locations, and dimensions shown on this plan are a true and correct record of the As Constructed information.
 Signed: [Signature] Cadastral Surveyor & Delegate, Reg. No 6448 Dated 31/10/2018



DRAWING REVISIONS		REFERENCE DRAWINGS		DESIGN FILE No.	DESIGNED
REV.	REVISION DESCRIPTION	DRG. No.	DESCRIPTION	CONSTRUCT. No.	DATE
A	Progress Plot			30105-18A100AB03	JMc
				FIELD BOOK	DATE 04/09/2019
				LOG BOOK	CHECKED JMc
				LEVEL DATUM	DATE 04/09/2019
				DATUM	AHD PM177891

veris
 BRISBANE (07) 3888 4700 WHITSUNDAYS (07) 4945 1722
 MACKAY (07) 4001 2011 CAIRNS (07) 4001 8722
 veris.com.au
 ACN 619 750 727
 Veris Australia Pty Ltd

Moreton Bay
 Regional Council

SCALE 1:100 ORIGINAL SIZE A1

MORETON BAY REGIONAL COUNCIL
 CABOOLTURE DISTRICT OFFICE
 2 HASKING STREET CABOOLTURE QLD 4510
 PO BOX 159 CABOOLTURE QLD 4510
 Telephone: (07) 5433 0100
 Fax: (07) 5433 4000

STAGE 18A, CAPESTONE
AS CONSTRUCTED
BIO BASIN D3

MBRC SUBDIVISION REFERENCE	
DA/36647/2018/V23R	
No. 1 OF 1 PLANS	
DRAWING NUMBER	REV.
30105-18A100 AB D2	A