

DRAFT COPY
ONLY

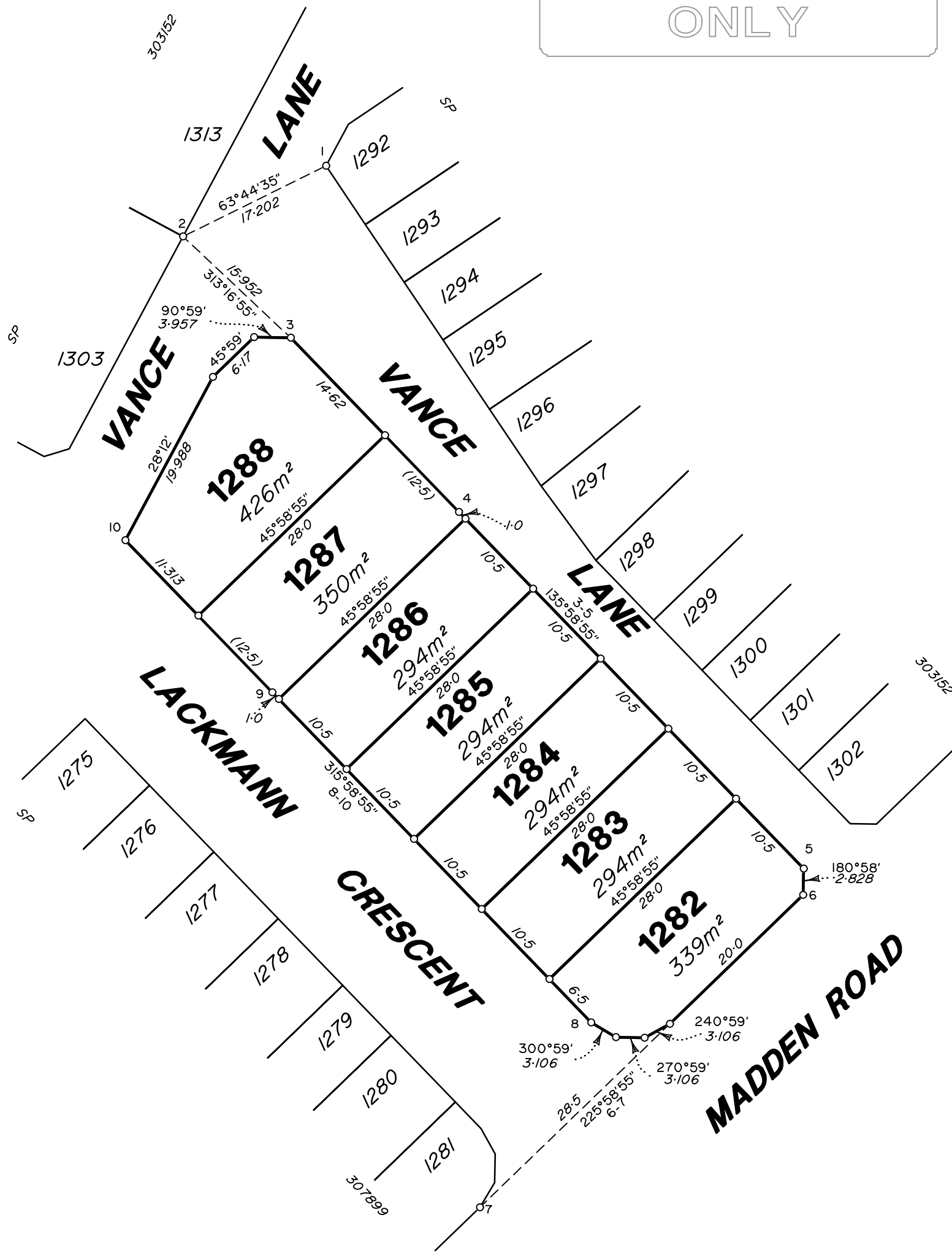

Scale 1:500 Lengths are in Metres

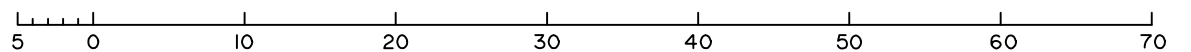

VERIS AUSTRALIA PTY LTD (ACN 615 735 727) hereby certify that the land comprised in this plan was surveyed by the corporation, by Daniel Michael COOK, Surveying Graduate, for whose work the corporation accepts responsibility, under the supervision of Peter John SIPPEL, Cadastral Surveyor, and that the plan is accurate, that the said survey was performed in accordance with the Survey and Mapping Infrastructure Act 2003 and Surveyors Act 2003 and associated Regulations and Standards and that the said survey was completed on.

..... Delegate

..... Date

| | | |
|---|--|---------------------------|
| Plan of Lots 1282-1288 | | Scale: 1:500 |
| Cancelling Lots 1282-1288 on SP307899 and Lots 1289-1291 on SP303152 Moreton Bay LOCAL GOVERNMENT: <i>Regional Council</i> LOCALITY: <i>MANGO HILL</i> | | Format: STANDARD |
| Meridian: <i>Zone 56 vide SP307899</i> | | Survey Records: <i>No</i> |
| SP315382 | | |

430105-12B

**WARNING : Folded or Mutilated Plans will not be accepted.
Plans may be rolled.
Information may not be placed in the outer margins.**

(Dealing No.)

5. Lodged by

(Include address, phone number, reference, and Lodger Code)

1. Certificate of Registered Owners or Lessees:

I/We Kinsella Heights Developments Pty Ltd
A.C.N. 100 373 368

(Names in full)

* as Registered Owners of this land agree to this plan and dedicate the Public Use Land as shown hereon in accordance with Section 50 of the Land Title Act 1994.

* as Lessees of this land agree to this plan.

Signature of * Registered Owners * ~~Lessees~~

* Rule out whichever is inapplicable

2. Planning Body Approval.

*
hereby approves this plan in accordance with the :
% *Planning Act 2016*

Dated this day of

..... #

..... #

* Insert the name of the Planning Body. % Insert applicable approving legislation
Insert designation of signatory or delegation

3. Plans with Community Management Statement :

CMS Number :

Name :

4. References :

Dept File :
Local Govt :
Surveyor : *430105-12B*

| 6. Existing | | Created | | |
|-----------------|----------------------|-------------|------|---------------------|
| Title Reference | Description | New Lots | Road | Secondary Interests |
| 51169923 | Lot 1282 on SP307899 | 1282 | — | — |
| 51169924 | Lot 1283 on SP307899 | 1282 & 1283 | — | — |
| 51169925 | Lot 1284 on SP307899 | 1283 & 1284 | — | — |
| 51169926 | Lot 1285 on SP307899 | 1284 | — | — |
| 51169927 | Lot 1286 on SP307899 | 1284 & 1285 | — | — |
| 51169928 | Lot 1287 on SP307899 | 1285 & 1286 | — | — |
| 51169929 | Lot 1288 on SP307899 | 1286 & 1287 | — | — |
| 51150754 | Lot 1289 on SP303152 | 1287 | — | — |
| 51150755 | Lot 1290 on SP303152 | 1287 & 1288 | — | — |
| 51150756 | Lot 1291 on SP303152 | 1288 | — | — |

DRAFT COPY
ONLY

9. Building Format Plans only.

I certify that :
* As far as it is practical to determine, no part of the building shown on this plan encroaches onto adjoining lots or road;
* Part of the building shown on this plan encroaches onto adjoining * lots and road

.....
Cadastrol Surveyor/Delegate * Date
* delete words not required

10. Lodgement Fees :

| | |
|------------------|----------|
| Survey Deposit | \$ |
| Lodgement | \$ |
| New Titles | \$ |
| Photocopy | \$ |
| Postage | \$ |
| TOTAL | \$ |

1282-1288 Por 396

| | |
|------|------|
| Lots | Orig |
|------|------|

7. Orig Grant Allocation :

11. Passed & Endorsed :

By : Veris Australia Pty Ltd
Date :
Signed :
Designation : *Delegate*

11. Insert Plan Number **SP315382**