

ENGINEER'S CERTIFICATION
 * I, DARRYL HAYTER
 being a Consulting Engineer and duly authorised representative of -
 EMPOWER ENGINEERS & PROJECT MANAGERS Pty Ltd
 hereby:-
 # certify the information contained in this drawing is an accurate "as constructed" representation of the works;
 # accept responsibility for the "as constructed" information contained in this drawing; and
 # acknowledge the "as constructed" information contained in the drawing may be relied on by the MORETON BAY REGIONAL COUNCIL and others.
 Certification for Stage 20B by [Signature] on 31/05/19.
 For: EMPOWER ENGINEERS & PROJECT MANAGERS Pty Ltd.
 RPEQ No: 5694

COORDINATE DATUM NOTE:
 HORIZONTAL COORDINATES(E,N) SUPPLIED ARE MAPPING GRID OF AUSTRALIA(MGA), ZONE 56 BASED ON THE UNIVERSAL TRANSVERSE MERCATOR PROJECTION AND THE GEOCENTRIC DATUM OF AUSTRALIA 1994.
 HORIZONTAL DATUM DERIVED FROM PSM160605, E 496434.400, N 7050402.659.
 LEVELS SUPPLIED ARE ON THE AUSTRALIAN HEIGHT DATUM(AHD)
 LEVEL DATUM DERIVED FROM PSM160605 RL 20.016 (AHD)

Registered Surveyor's certification
 We, VERIS AUSTRALIA Pty Ltd, hereby certify that the vertical and horizontal locations, and dimensions shown on this plan are a true and correct record and were located by survey.
 [Signature] 6448 28/05/2019
 Delegate Cadastral Surveyor Date

PSM160605
 E: 496434.400
 N: 7050402.659
 RL: 20.016m

A1	INDEX	DATE	REVISIONS	DRAWN	CHECKED	PASSED	INITIALS	DATE			MORETON BAY REGIONAL COUNCIL CABOOLTURE DISTRICT OFFICE 2 HASKING STREET CABOOLTURE QLD 4510 PO BOX 159 CABOOLTURE QLD 4510 Telephone: (07) 5433 0100 Fax: (07) 5433 4000	DA/36071/2018/V23R	SHEET 2 OF 3 SHEETS	SCALE 1:250
	A	28/05/2019	ORIGINAL	JMc	JMc							DRAWN JMc 28/05/2019 CHECKED JMc 28/05/2019 PASSED DISCIPLINE CODE C DRAWING NO. 30105-20B100 AD01 (A)	STAGE 20B CAPESTONE ESTATE AS CONSTRUCTED STORMWATER DRAINAGE	REVISION DATE REVISION

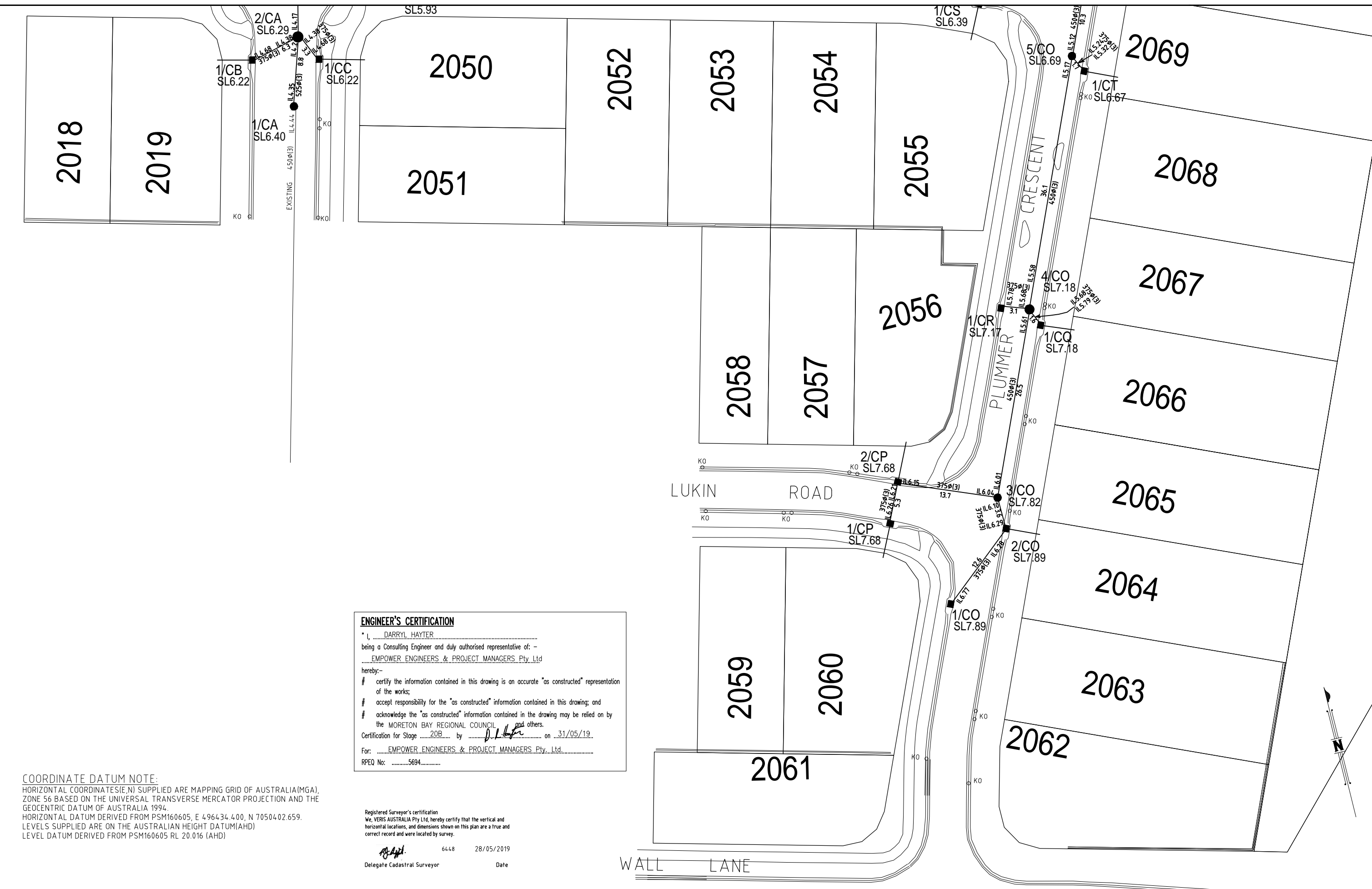

ENGINEER'S CERTIFICATION
 * I, DARRYL HAYTER
 being a Consulting Engineer and duly authorised representative of: -
EMPOWER ENGINEERS & PROJECT MANAGERS Pty Ltd
 hereby:-
 # certify the information contained in this drawing is an accurate "as constructed" representation of the works;
 # accept responsibility for the "as constructed" information contained in this drawing; and
 # acknowledge the "as constructed" information contained in the drawing may be relied on by the MORETON BAY REGIONAL COUNCIL and others.
 Certification for Stage 20B by D. Hayter on 31/05/19
 For: EMPOWER ENGINEERS & PROJECT MANAGERS Pty Ltd
 RPEQ No: 5694

Registered Surveyor's certification
 We, VERIS AUSTRALIA Pty Ltd, hereby certify that the vertical and horizontal locations, and dimensions shown on this plan are a true and correct record and were located by survey.
6448 28/05/2019
 Delegate Cadastral Surveyor Date

COORDINATE DATUM NOTE:
 HORIZONTAL COORDINATES(E,N) SUPPLIED ARE MAPPING GRID OF AUSTRALIA(MGA), ZONE 56 BASED ON THE UNIVERSAL TRANSVERSE MERCATOR PROJECTION AND THE GEOCENTRIC DATUM OF AUSTRALIA 1994.
 HORIZONTAL DATUM DERIVED FROM PSM160605, E 496434.400, N 705042.659.
 LEVELS SUPPLIED ARE ON THE AUSTRALIAN HEIGHT DATUM(AHD)
 LEVEL DATUM DERIVED FROM PSM160605 RL 20.016 (AHD)

A1	INDEX	DATE	REVISIONS	DRAWN	CHECKED	PASSED	INITIALS	DATE
	A	28/05/2019	ORIGINAL	JMc	JMc			

BRISBANE PROSPELINE
 (07) 3666 4700 (07) 4945 1722
 MACKAY CAIRNS
 (07) 4991 2011 (07) 4991 6122
 VERIS.COM.AU
 ACN 604 671 374
 Queensland Surveying Pty Ltd, a Veris Company

Moreton Bay
 Regional Council

MORETON BAY REGIONAL COUNCIL
 CABOOLTURE DISTRICT OFFICE
 2 HASKING STREET CABOOLTURE QLD 4510
 PO BOX 159 CABOOLTURE QLD 4510
 Telephone: (07) 5433 0100
 Fax: (07) 5433 4000

DA/36071/2018/V23R
 STAGE 20B
 CAPESTONE ESTATE
 AS CONSTRUCTED
 STORMWATER DRAINAGE

SHEET 3 OF 3 SHEETS	SCALE 1:250
REVISION DATE	REVISION
DISCIPLINE CODE C	
DRAWING NO. 30105-20B100 AD01 (A)	