

- LEGEND**
- New Hydrant
 - New Isolation Valve
 - New End Cap
 - New Scour Valve
 - New Taper
 - New Water Service Conduit (Ø100 uPVC PN9)
 - New Water Meter
 - New Water House connection

REGISTERED SURVEYOR'S CERTIFICATION
 We, Queensland Surveying Pty Ltd (ACN 604 671 374) Cadastral Surveyors, hereby certify that the vertical and horizontal locations and dimensions shown on this plan are a true and correct record and were located by survey.
 Delegate (signature) *[Signature]* 6152 16/11/2017
 Registration ID Date

ENGINEER'S CERTIFICATION
 I, DARRYL HAYTER
 being a Consulting Engineer and duly authorised representative of: -
EMPOWER ENGINEERS AND PROJECT MANAGERS
 hereby:-
 # certify the information contained in this drawing is an accurate "as constructed" representation of the works;
 # accept responsibility for the "as constructed" information contained in this drawing; and
 # acknowledge the "as constructed" information contained in the drawing may be relied on by the Moreton Bay Regional Council and others.
 Certification for Stage 19 by *[Signature]* on 24/11/17
 For: EMPOWER ENGINEERS AND PROJECT MANAGERS RPEQ 5694

A1	C	16/11/2017	UPDATE	EJM	EJM
	B	10/11/2017	UPDATE	EJM	EJM
	A	1/9/2017	PROGRESS PLOT	EJM	EJM
	INDEX	DATE	REVISIONS	DRAWN	CHECKED

DRAWN	EJM	10/11/2017
CHECKED	EJM	10/11/2017
PASSED	-	-
INITIALS		DATE

BRISBANE 071 488 4700
 MACKEY 071 488 2811
 PROSERPINE 071 488 1722
 CAIRNS 071 488 8722
 veris.com.au
 ACN 604 671 374
 Queensland Surveying Pty Ltd, a Veris Company



Unitywater
 AS-CONSTRUCTED WATER STAGE 19, CAPESTONE

SCALE	1:500
SHEET	1 OF 2 SHEETS
DRAWING NO.	30105-190100-AW01
	C B A

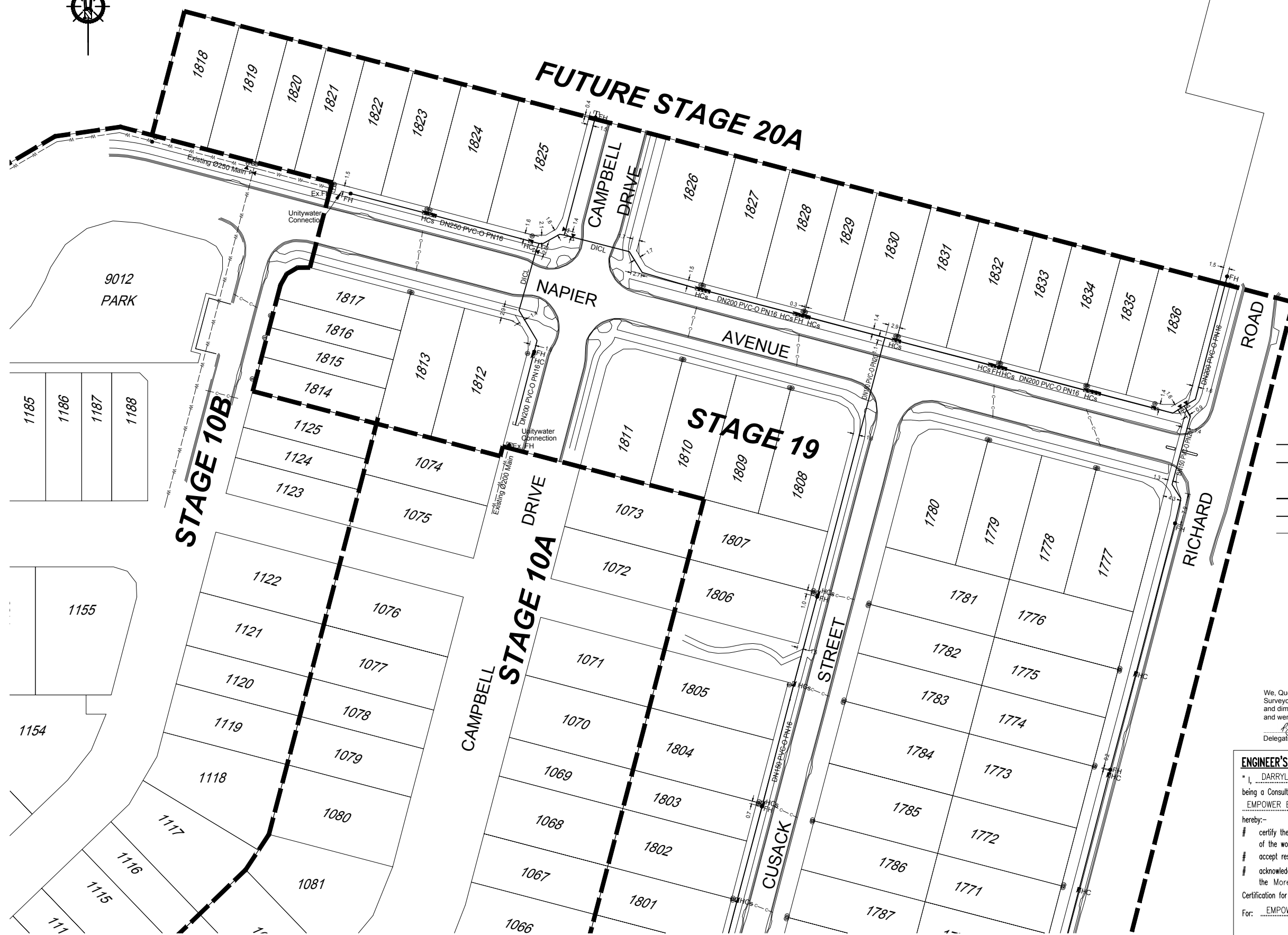

○ PM55164

- LEGEND**
- New Hydrant
 - New Isolation Valve
 - New End Cap
 - New Scour Valve
 - New Taper
 - New Water Service Conduit (Ø100 uPVC PN9)
 - New Water Meter
 - New Water House connection

REGISTERED SURVEYOR'S CERTIFICATION

We, Queensland Surveying Pty Ltd (ACN 604 671 374) Cadastral Surveyors, hereby certify that the vertical and horizontal locations and dimensions shown on this plan are a true and correct record and were located by survey.

Delegate (signature) *[Signature]* 6152 16/11/2017
Registration ID Date

ENGINEER'S CERTIFICATION

I, DARRYL HAYTER
being a Consulting Engineer and duly authorised representative of: -
EMPOWER ENGINEERS AND PROJECT MANAGERS
hereby:-
certify the information contained in this drawing is an accurate "as constructed" representation of the works;
accept responsibility for the "as constructed" information contained in this drawing; and
acknowledge the "as constructed" information contained in the drawing may be relied on by the Moreton Bay Regional Council and others.
Certification for Stage 19 by *[Signature]* on 24/11/17
For: EMPOWER ENGINEERS AND PROJECT MANAGERS RPEQ 5694

A1

INDEX	DATE	REVISIONS	DRAWN	CHECKED	PASSED
C	16/11/2017	UPDATE	EJM	EJM	
B	2/11/2017	UPDATE	EJM	EJM	
A	1/9/2017	PROGRESS PLOT	EJM	EJM	

INITIALS	DATE
DRAWN	16/11/2017
CHECKED	16/11/2017
PASSED	-

veris
BRISBANE 071 488 4700
MACKAY 071 488 1811
PROSERPINE 071 488 1722
CAIRNS 071 488 1722
veris.com.au
ACN 604 671 374
Queensland Surveying Pty Ltd, a Veris Company



Unitywater
AS-CONSTRUCTED
WATER
STAGE 19, CAPESTONE

SCALE	1:500
SHEET	2 OF 2 SHEETS
DRAWING NO.	30105-190100-AW01