

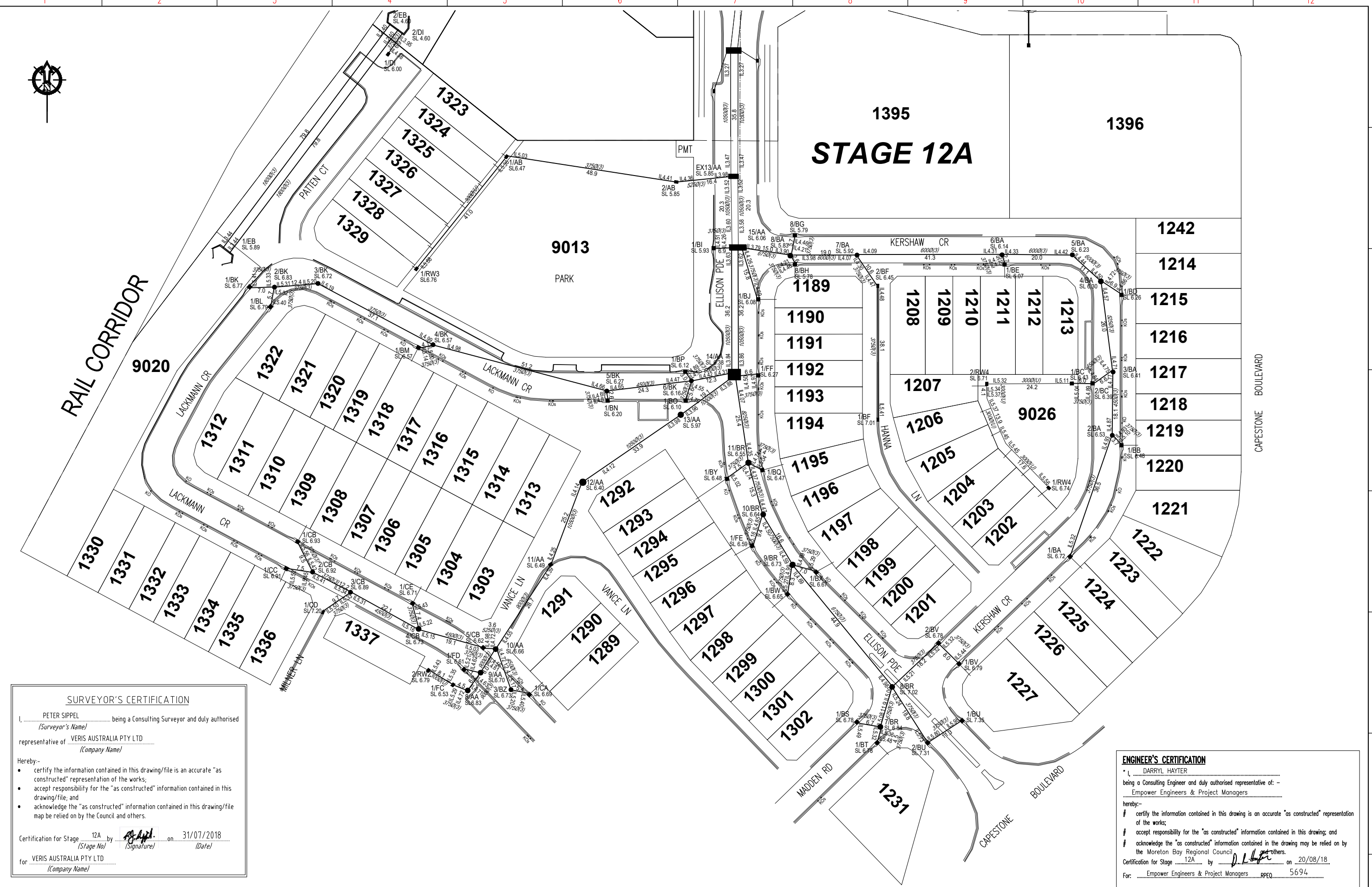

STAGE 12A

RAIL CORRIDOR

CAPESTONE BOULEVARD



SURVEYOR'S CERTIFICATION

I, PETER SIPPPEL being a Consulting Surveyor and duly authorised
(Surveyor's Name)
 representative of VERIS AUSTRALIA PTY LTD
(Company Name)

Hereby:-

- certify the information contained in this drawing/file is an accurate "as constructed" representation of the works;
- accept responsibility for the "as constructed" information contained in this drawing/file; and
- acknowledge the "as constructed" information contained in this drawing/file may be relied on by the Council and others.

Certification for Stage 12A by *P. SipppeL* on 31/07/2018
(Stage No) *(Signature)* *(Date)*
 for VERIS AUSTRALIA PTY LTD
(Company Name)

ENGINEER'S CERTIFICATION

I, DARRYL HAYTER
 being a Consulting Engineer and duly authorized representative of: -
 Empower Engineers & Project Managers

hereby:-

- certify the information contained in this drawing is an accurate "as constructed" representation of the works;
- accept responsibility for the "as constructed" information contained in this drawing; and
- acknowledge the "as constructed" information contained in the drawing may be relied on by the Moreton Bay Regional Council and others.

Certification for Stage 12A by *D. Hayter* on 20/08/18
(Stage No) *(Signature)* *(Date)*
 For Empower Engineers & Project Managers RPEQ 5694

REV.	DRAWING REVISIONS	REFERENCE DRAWINGS	DESIGN FILE No.	DESIGNED
A	AS CONSTRUCTED	DRG. No. DESCRIPTION	CONSTRUCT. No. SURVEY FILE No. 30105-12A100 AD	DATE DRAWN JMc
			FIELD BOOK	DATE 31/07/2018
			LOG BOOK	CHECKED JMc
			LEVEL DATUM	DATE 31/07/2018
			DATUM	AHD PM177891

THIS WORK WAS PREPARED BY:
VERIS AUSTRALIA PTY LTD

SCALE 1:500 ORIGINAL SIZE A1

MORETON BAY REGIONAL COUNCIL
 CABOOLTURE DISTRICT OFFICE
 2 HASKING STREET CABOOLTURE QLD 4510
 PO BOX 159 CABOOLTURE QLD 4510
 Telephone: (07) 5433 0100
 Fax: (07) 5433 4000

STAGE 12A, CAPESTONE
AS CONSTRUCTED
DRAINAGE

MBRC SUBDIVISION REFERENCE	
DA/30479/2015/VCHG/2	
No. 1 OF 1 PLANS	
DRAWING NUMBER	REV.
30105-12A100 AD	A