



I, Peter Sippel being a cadastral surveyor and duly authorised representative of THG WSG Pty Ltd hereby:

- certify the information contained in this drawing is an accurate as constructed representation of the works
- accept responsibility for the as constructed information contained in this drawing
- acknowledge the as constructed information contained in the drawing may be relied on by council and others

Certification of Stage 4 External by [Signature] on 24/11/14  
(Signature) (Date)

for THG WSG Pty Ltd

- LEGEND**
- New Hydrant
  - New Valve
  - New End Cap
  - New Air Valve
  - New Scour Valve

46020

**FUTURE STAGES**

**ENGINEER'S CERTIFICATION**

I, David Polden being a Consulting Engineer and duly authorised representative of: - BMD Consulting hereby:-

- certify the information contained in this drawing is an accurate "as constructed" representation of the works;
- accept responsibility for the "as constructed" information contained in this drawing; and
- acknowledge the "as constructed" information contained in the drawing may be relied on by the Moreton Bay Regional Council and others.

Certification for Stage 4 by [Signature] on 25.11.14

For: BMD CONSULTING Pty. Ltd. RPEQ 1907

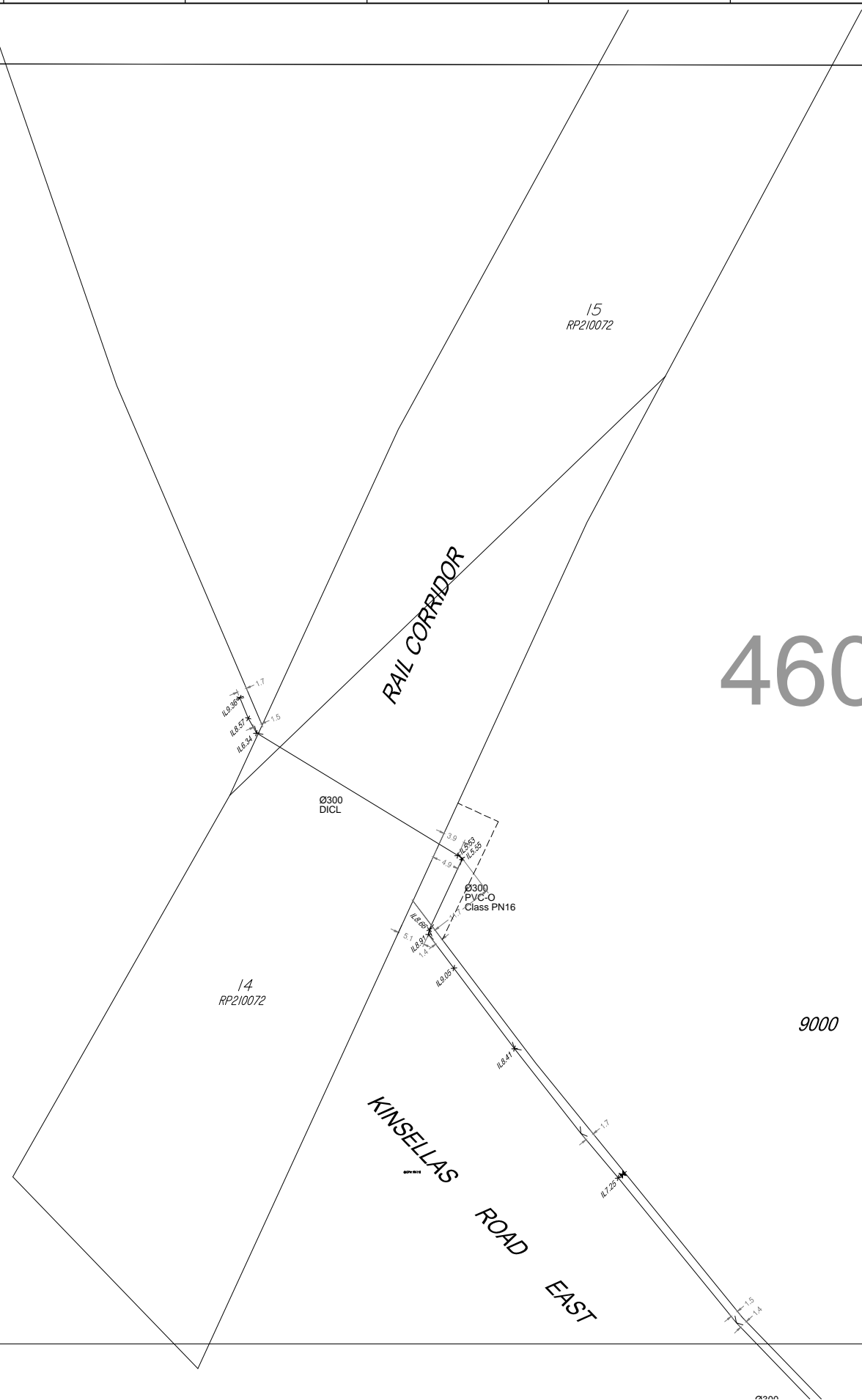

| DRAWING REVISIONS |                      | REFERENCE DRAWINGS |             | DESIGN FILE No.              | DESIGNED      |
|-------------------|----------------------|--------------------|-------------|------------------------------|---------------|
| REV.              | REVISION DESCRIPTION | DRG. No.           | DESCRIPTION | CONSTRUCT. No.               | DATE          |
| A                 | Original             |                    |             | SURVEY FILE No. 247404_10 AW | DRAWN EJM     |
| B                 | Update               |                    |             | FIELD BOOK                   | DATE 24/11/14 |
| C                 | Update               |                    |             | LOG BOOK                     | CHECKED EJM   |
|                   |                      |                    |             | LEVEL DATUM AHD              | DATE 24/11/14 |
|                   |                      |                    |             | DATUM PM137449               |               |

**THIS WORK WAS PREPARED BY:**  
**THG WSG PTY LTD**

SCALE 1:500 ORIGINAL SIZE A1



**MORETON BAY REGIONAL COUNCIL**  
CABOOLTURE DISTRICT OFFICE  
2 HASKING STREET CABOOLTURE QLD 4510  
PO BOX 159 CABOOLTURE QLD 4510  
Telephone: (07) 5433 0100  
Fax: (07) 5433 4000

**STAGE 4, CAPESTONE AS CONSTRUCTED EXTERNAL WATER MAIN**

|                            |      |
|----------------------------|------|
| MBRC SUBDIVISION REFERENCE |      |
| DA/27987/2013/V23R         |      |
| No. 1 OF 3 PLANS           |      |
| ASCAN GRID NUMBER          | REV. |
| 46020                      | C    |



I, Peter Sippel, being a cadastral surveyor and duly authorised representative of THG WSG Pty Ltd hereby:

- certify the information contained in this drawing is an accurate as constructed representation of the works
- accept responsibility for the as constructed information contained in this drawing
- acknowledge the as constructed information contained in the drawing may be relied on by council and others

Certification of Stage 4 External by *P. Sippel* on 24/11/14  
(Signature) (Date)

for THG WSG Pty Ltd

# FUTURE STAGES

**ENGINEER'S CERTIFICATION**

I, David Polden, being a Consulting Engineer and duly authorised representative of: - BMD Consulting hereby:

- certify the information contained in this drawing is an accurate "as constructed" representation of the works;
- accept responsibility for the "as constructed" information contained in this drawing; and
- acknowledge the "as constructed" information contained in the drawing may be relied on by the Moreton Bay Regional Council and others.

Certification for Stage 4 by *[Signature]* on 25.11.14  
For: BMD CONSULTING Pty. Ltd. RPEQ 1907

- LEGEND**
- New Hydrant
  - ✕ New Valve
  - ⊥ New End Cap
  - New Air Valve
  - ✱ New Scour Valve

9000

46021



| DRAWING REVISIONS |                      | REFERENCE DRAWINGS |             | DESIGN FILE No. | DESIGNED |
|-------------------|----------------------|--------------------|-------------|-----------------|----------|
| REV.              | REVISION DESCRIPTION | DRG. No.           | DESCRIPTION | CONSTRUCT. No.  | DATE     |
| A                 | Original             |                    |             | 247404_10 AW    | EJM      |
| B                 | Update               |                    |             |                 | 24/11/14 |
| C                 | Update               |                    |             |                 | EJM      |
|                   |                      |                    |             | LOG BOOK        | CHECKED  |
|                   |                      |                    |             | LEVEL DATUM     | DATE     |
|                   |                      |                    |             | DATUM           |          |

**THIS WORK WAS PREPARED BY:**  
**THG WSG PTY LTD**

SCALE 1:500 ORIGINAL SIZE A1



**MORETON BAY REGIONAL COUNCIL**  
CABOOLTURE DISTRICT OFFICE  
2 HASKING STREET CABOOLTURE QLD 4510  
PO BOX 159 CABOOLTURE QLD 4510  
Telephone: (07) 5433 0100  
Fax: (07) 5433 4000

**STAGE 4, CAPESTONE  
AS CONSTRUCTED  
EXTERNAL WATER MAIN**

| MBRC SUBDIVISION REFERENCE |      |
|----------------------------|------|
| DA/27987/2013/V23R         |      |
| No. 2 OF 3 PLANS           |      |
| ASCON GRID NUMBER          | REV. |
| 46021                      | C    |



I, Peter Sippel being a cadastral surveyor and duly authorised representative of THG WSG Pty Ltd hereby:

- certify the information contained in this drawing is an accurate as constructed representation of the works
- accept responsibility for the as constructed information contained in this drawing
- acknowledge the as constructed information contained in the drawing may be relied on by council and others

Certification of Stage 4 External by P. Sippel on 24/11/14  
(Signature) (Date)  
for THG WSG Pty Ltd

- LEGEND**
- New Hydrant
  - New Valve
  - New End Cap
  - New Air Valve
  - New Scour Valve

**ENGINEER'S CERTIFICATION**

I, David Polden being a Consulting Engineer and duly authorised representative of: -  
BMD Consulting  
hereby:-

- certify the information contained in this drawing is an accurate "as constructed" representation of the works;
- accept responsibility for the "as constructed" information contained in this drawing; and
- acknowledge the "as constructed" information contained in the drawing may be relied on by the Moreton Bay Regional Council and others.

Certification for Stage 4 by [Signature] on 25.11.14  
For: BMD CONSULTING Pty. Ltd. RPEQ 1907

46187

Ø300  
PVC-O  
Class PN16  
(1.5m)

9000

CAPESTONE BOULEVARD

KINSELLAS ROAD EAST

STAGE 4

| DRAWING REVISIONS |                      | REFERENCE DRAWINGS |             | DESIGN FILE No. | DESIGNED |
|-------------------|----------------------|--------------------|-------------|-----------------|----------|
| REV.              | REVISION DESCRIPTION | DRG. No.           | DESCRIPTION | CONSTRUCT. No.  | DATE     |
| A                 | Original             |                    |             | 247404_10 AW    | 24/11/14 |
| B                 | Update               |                    |             |                 | 24/11/14 |
| C                 | Update               |                    |             |                 | 24/11/14 |

**THIS WORK WAS PREPARED BY:**  
**THG WSG PTY LTD**

SCALE 1:500 ORIGINAL SIZE A1



**MORETON BAY REGIONAL COUNCIL**  
CABOOLTURE DISTRICT OFFICE  
2 HASKING STREET CABOOLTURE QLD 4510  
PO BOX 159 CABOOLTURE QLD 4510  
Telephone: (07) 5433 0100  
Fax: (07) 5433 4000

**STAGE 4, CAPESTONE  
AS CONSTRUCTED  
EXTERNAL WATER MAIN**

| MBRC SUBDIVISION REFERENCE |      |
|----------------------------|------|
| DA/27987/2013/V23R         |      |
| No. 3 OF 3 PLANS           |      |
| ASCEN GRID NUMBER          | REV. |
| 46187                      | C    |