



I, Peter Sippel being a cadastral surveyor and duly authorised representative of THG WSG Pty Ltd hereby:

- certify the information contained in this drawing is an accurate as constructed representation of the works
- accept responsibility for the as constructed information contained in this drawing
- acknowledge the as constructed information contained in the drawing may be relied on by council and others

Certification of Stage 4 by [Signature] on 6/11/14
 (Signature) (Date)
 for THG WSG Pty Ltd

ENGINEER'S CERTIFICATION

I, David Polden being a Consulting Engineer and duly authorised representative of: -
BMD Consulting
 hereby:-
 # certify the information contained in this drawing is an accurate "as constructed" representation of the works;
 # accept responsibility for the "as constructed" information contained in this drawing; and
 # acknowledge the "as constructed" information contained in the drawing may be relied on by the Moreton Bay Regional Council and others.
 Certification for Stage 4 by [Signature] on 25.11.14
 For: BMD CONSULTING Pty. Ltd. RPEQ 1907

LEGEND

- New Hydrant
- New Valve
- New End Cap
- New Water Service Conduit (Indicative Only)
- New Water Service point of entry (Indicative Only)
- New Water House connection (Indicative Only)

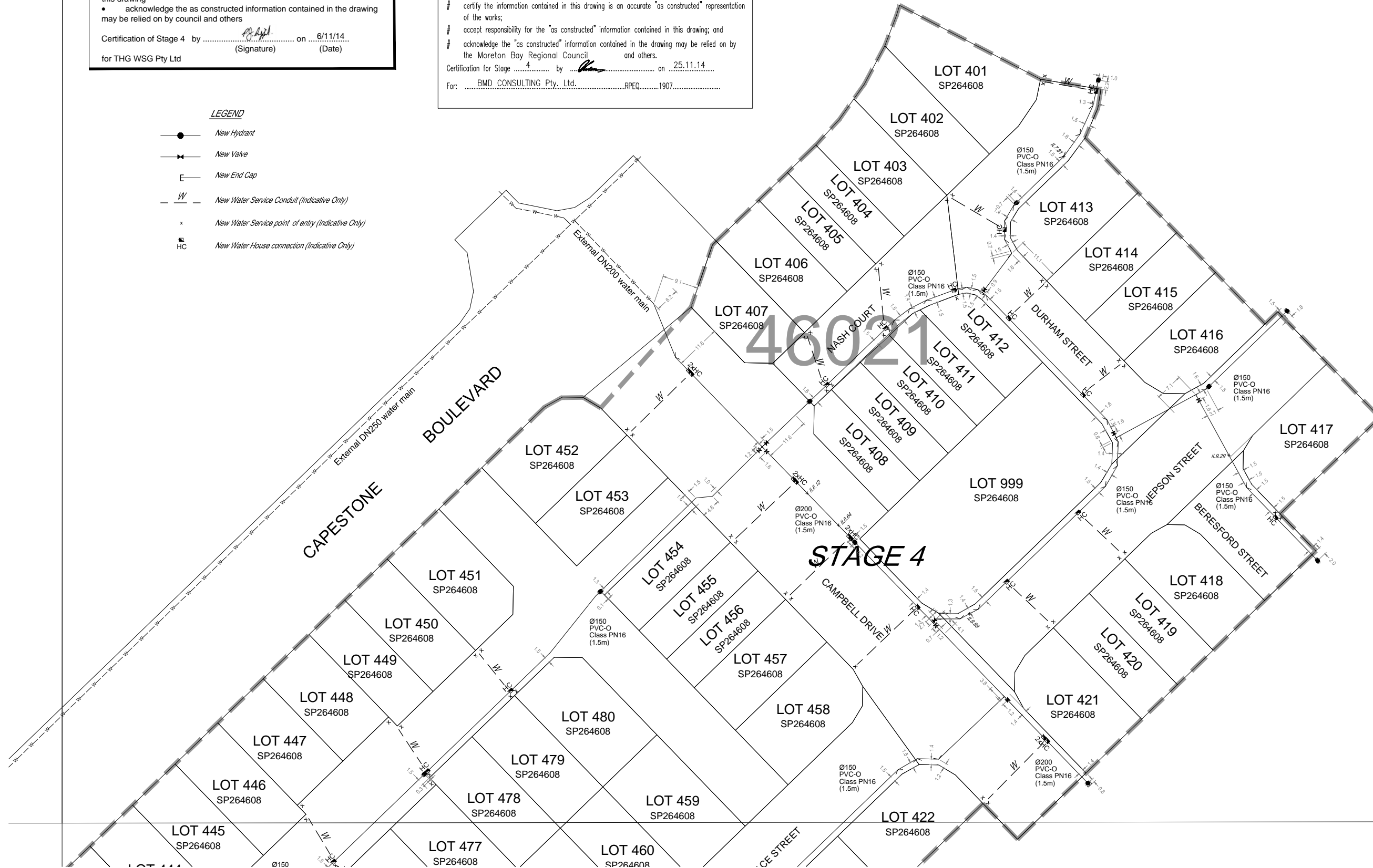

| DRAWING REVISIONS | | REFERENCE DRAWINGS | | DESIGN FILE No. | DESIGNED |
|-------------------|----------------------|--------------------|-------------|-----------------|----------|
| REV. | REVISION DESCRIPTION | DRG. No. | DESCRIPTION | CONSTRUCT. No. | DATE |
| A | Original | | | | |
| B | Update | | | | |

| DESIGNED | CHECKED | DATE |
|----------|---------|---------|
| EJM | EJM | 6/11/14 |
| | | 6/11/14 |

| DESIGN FILE No. | CONSTRUCT. No. | DESIGNED | CHECKED | DATE |
|-----------------|----------------|----------|---------|---------|
| 247404_9 AW | | EJM | EJM | 6/11/14 |
| | | | | |

THIS WORK WAS PREPARED BY:
THG WSG PTY LTD

SCALE 1:500 ORIGINAL SIZE A1

MORETON BAY REGIONAL COUNCIL
 CABOOLTURE DISTRICT OFFICE
 2 HASKING STREET CABOOLTURE QLD 4510
 PO BOX 159 CABOOLTURE QLD 4510
 Telephone: (07) 5433 0100
 Fax: (07) 5433 4000

STAGE 4, CAPESTONE AS CONSTRUCTED WATER RETICULATION

| MBRC SUBDIVISION REFERENCE | |
|----------------------------|------|
| DA/27987/2013/V23R | |
| No. 1 OF 3 PLANS | |
| ASCON GRID NUMBER | REV. |
| 46021 | B |



I, Peter Sippel being a cadastral surveyor and duly authorised representative of THG WSG Pty Ltd hereby:

- certify the information contained in this drawing is an accurate as constructed representation of the works
- accept responsibility for the as constructed information contained in this drawing
- acknowledge the as constructed information contained in the drawing may be relied on by council and others

Certification of Stage 4 by [Signature] on 6/11/14
(Signature) (Date)
for THG WSG Pty Ltd

ENGINEER'S CERTIFICATION

I, David Polden being a Consulting Engineer and duly authorised representative of: -
BMD Consulting
hereby:-

- certify the information contained in this drawing is an accurate "as constructed" representation of the works;
- accept responsibility for the "as constructed" information contained in this drawing; and
- acknowledge the "as constructed" information contained in the drawing may be relied on by the Moreton Bay Regional Council and others.

Certification for Stage 4 by [Signature] on 25.11.14
For: BMD CONSULTING Pty. Ltd. RPEQ 1907

LEGEND

- New Hydrant
- New Valve
- New End Cap
- New Water Service Conduit (Indicative Only)
- New Water Service point of entry (Indicative Only)
- New Water House connection (Indicative Only)

46187

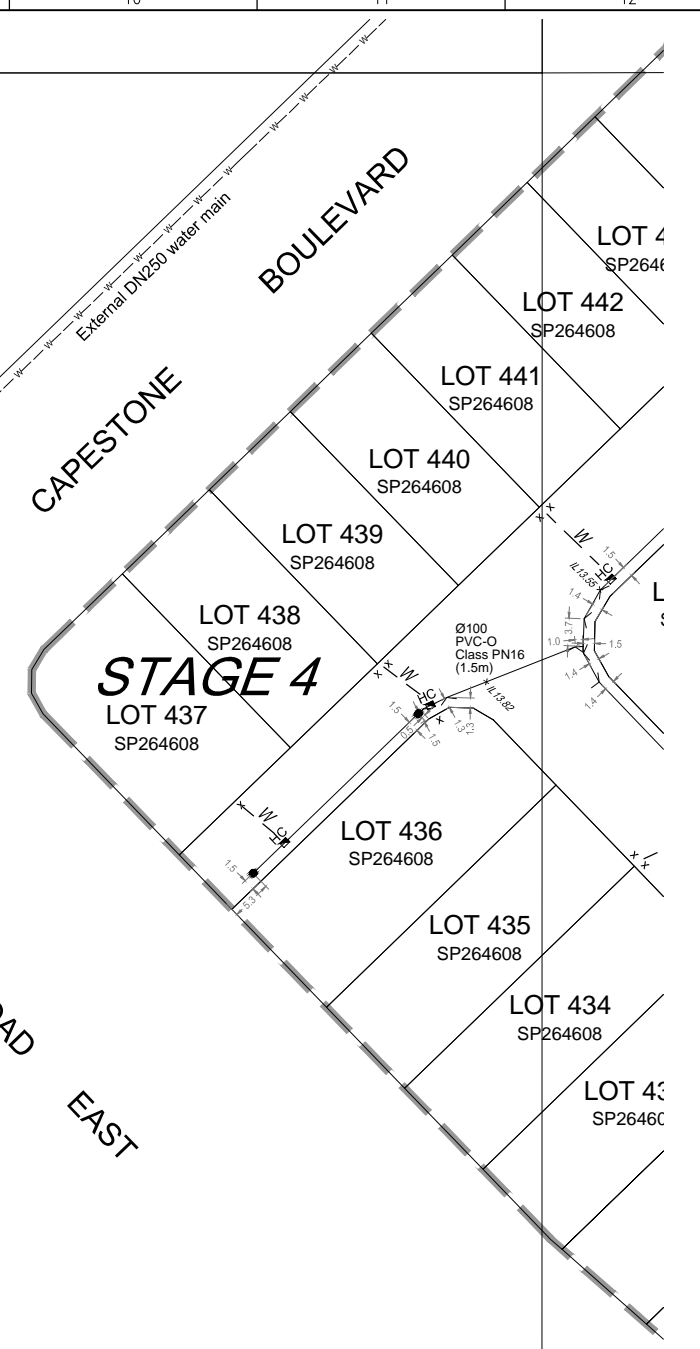

| DRAWING REVISIONS | | REFERENCE DRAWINGS | | DESIGN FILE No. | DESIGNED | THIS WORK WAS PREPARED BY: THG WSG PTY LTD | | MORETON BAY REGIONAL COUNCIL CABOOLTURE DISTRICT OFFICE 2 HASKING STREET CABOOLTURE QLD 4510 PO BOX 159 CABOOLTURE QLD 4510 Telephone: (07) 5433 0100 Fax: (07) 5433 4000 | MBRC SUBDIVISION REFERENCE | | | | |
|-------------------|----------------------|--------------------|-------------|-----------------|----------|---|--|---|----------------------------|--------------|------|--------------------|-------------------|
| REV. | REVISION DESCRIPTION | DRG. No. | DESCRIPTION | CONSTRUCT. No. | DATE | | | | DATE | DATE | DATE | DA/27987/2013/V23R | |
| A | Original | | | | | | | | 6/11/14 | EJM | | | No. 2 OF 3 PLANS |
| B | Update | | | 247404_9 AW | | | | | 6/11/14 | EJM | | | ASCEN GRID NUMBER |
| | | | | | | | | | | REV. | | | |
| | | | | | | | | | | 46187 | | | |
| | | | | | | | | | | B | | | |

SCALE 1:500 ORIGINAL SIZE A1

**STAGE 4, CAPESTONE
AS CONSTRUCTED
WATER RETICULATION**

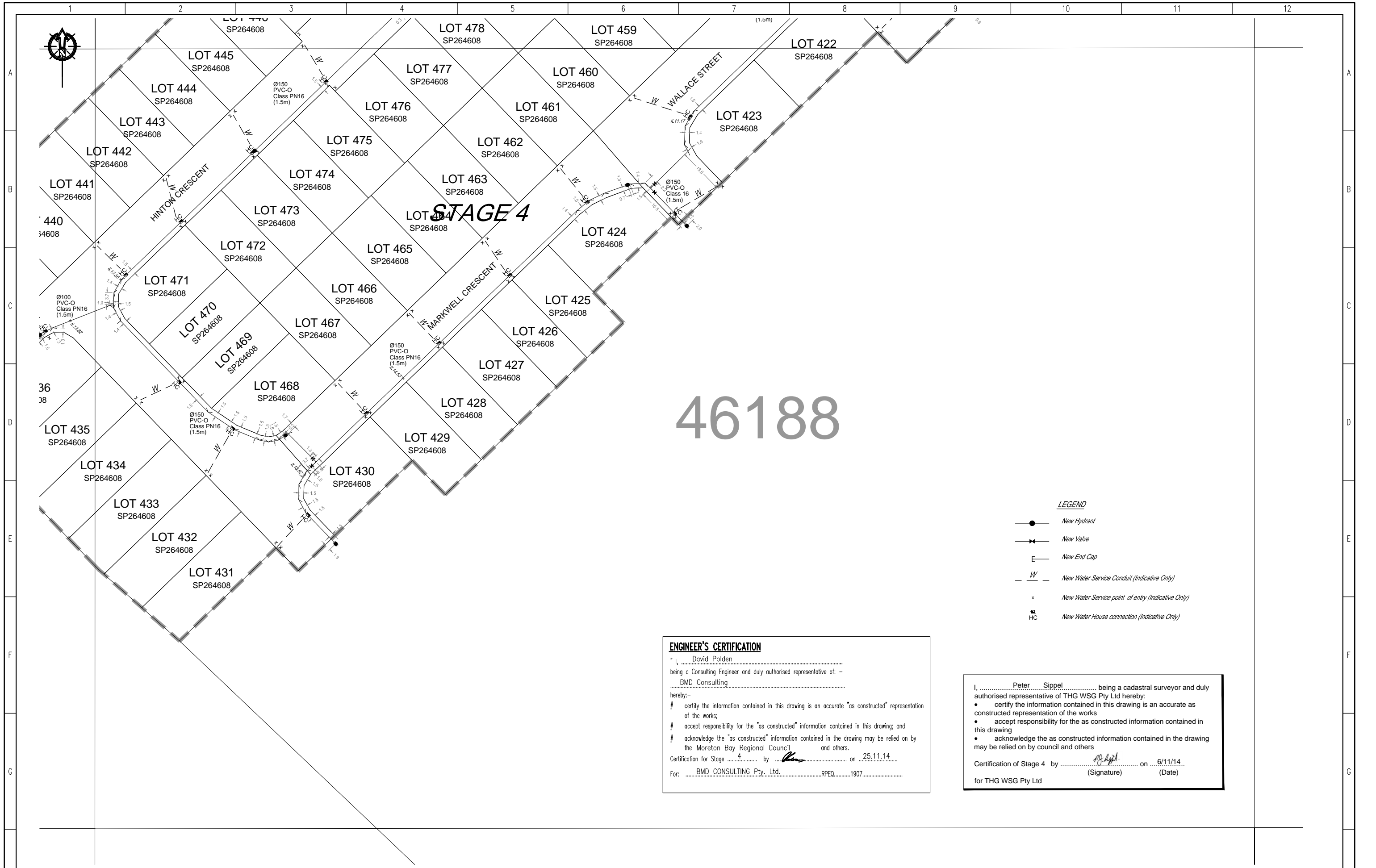

- LEGEND**
- New Hydrant
 - ✕ New Valve
 - New End Cap
 - W New Water Service Conduit (Indicative Only)
 - x New Water Service point of entry (Indicative Only)
 - HC New Water House connection (Indicative Only)

ENGINEER'S CERTIFICATION
 I, David Polden
 being a Consulting Engineer and duly authorised representative of: -
 BMD Consulting
 hereby:-
 # certify the information contained in this drawing is an accurate "as constructed" representation of the works;
 # accept responsibility for the "as constructed" information contained in this drawing; and
 # acknowledge the "as constructed" information contained in the drawing may be relied on by the Moreton Bay Regional Council and others.
 Certification for Stage 4 by [Signature] on 25.11.14
 For: BMD CONSULTING Pty. Ltd. RPEQ 1907

I, Peter Sippel being a cadastral surveyor and duly authorised representative of THG WSG Pty Ltd hereby:
 • certify the information contained in this drawing is an accurate as constructed representation of the works
 • accept responsibility for the as constructed information contained in this drawing
 • acknowledge the as constructed information contained in the drawing may be relied on by council and others
 Certification of Stage 4 by [Signature] on 6/11/14
 for THG WSG Pty Ltd (Signature) (Date)

| | | | | | | | | | | |
|-------------------|----------------------|--------------------|-------------|-----------------|----------|---|--|---|----------------------------|------|
| DRAWING REVISIONS | | REFERENCE DRAWINGS | | DESIGN FILE No. | DESIGNED | THIS WORK WAS PREPARED BY: THG WSG PTY LTD | | MORETON BAY REGIONAL COUNCIL CABOOLTURE DISTRICT OFFICE 2 HASKING STREET CABOOLTURE QLD 4510 Telephone: (07) 5433 0100 Fax: (07) 5433 4000 | MBRC SUBDIVISION REFERENCE | |
| REV. | REVISION DESCRIPTION | DRG. No. | DESCRIPTION | CONSTRUCT. No. | DATE | | | | DA/27987/2013/V23R | |
| A | Original | | | SURVEY FILE No. | 6/11/14 | | | | No. 3 OF 3 PLANS | |
| B | Update | | | FIELD BOOK | EJM | | | | ASCAN GRID NUMBER | REV. |
| | | | | LOG BOOK | EJM | | | | 46188 | B |
| | | | | LEVEL DATUM | 6/11/14 | SCALE 1:500 ORIGINAL SIZE A1 | | | | |
| | | | | DATUM | PM137449 | | | | | |