

Context Plan (NTS)

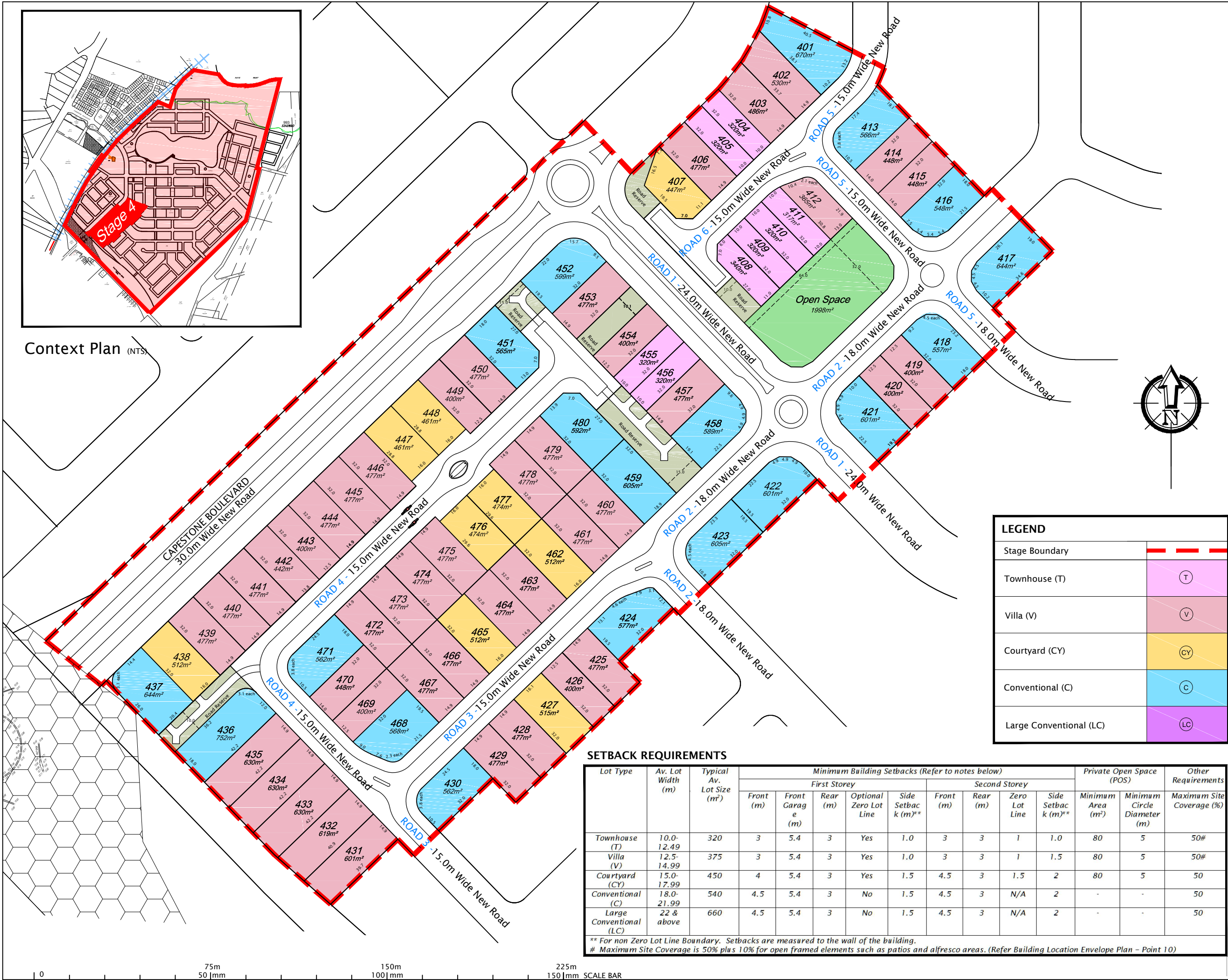

CAPESTONE

For  
URBEX

**IMPORTANT NOTES:**  
(These notes are an integral part of this plan)  
This plan has been prepared for Urbex for the purposes of a Setback Plan. This plan is intended for discussion purposes only and should not be used for any other purposes. No investigations have been undertaken by THG WSG Pty Ltd over this area of land other than to sight the registered plan and topographical map. The Contours, boundaries, creek line, flood lines, building locations have all been scaled and should not have any reliance based on them as they are only intended as a general guide. Any comments contained on this plan should be confirmed by the relevant authorities. The dimensions, areas and total number of lots shown hereon are subject to field survey and also to the requirements of Council and any other authority which may have requirements under any relevant legislation. In particular, no reliance should be placed on the information on this plan for any financial dealings involving the land.

It is not to be used by any other person or corporation or for any other purposes and is subject to the following limitations:

The title boundaries as shown hereon have been determined from minimum connections to survey marks placed by others and then from measurements by others, the verification of which does not form part of this survey.

No report is made on any underground services on or adjacent to the site.

Copyright © THG WSG Pty Ltd t/a THG Resource Strategists 10.07.2013

THESE DESIGNS AND DRAWINGS ARE COPYRIGHT AND ARE NOT TO BE USED OR REPRODUCED WITHOUT THE WRITTEN PERMISSION OF THG

Data Sources  
Cadastral Boundaries 30105-GP04-C  
Contours / Topographic 30105-GP04-C

Revision	Date	Chkd
D	Truncate Lot 407	06/06/14 KS
C	Amend Lots and Truncations	08.04.14 KS
B	Re-Align 30m Road & RFI	05.11.13 KS
A	ORIGINAL	10.07.13 AN/KS
No	Revisions	Date Chkd

Parish: REDCLIFFE  
County: STANLEY  
Locality: MANGO HILL  
Local Authority: MBRC  
Map Reference : 9543-43323  
Horizontal Meridian: MGA  
Vertical Level Datum: AHD  
Level Origin: PM38847  
Scale: 1:1500 @ A3  
Surveyed: HSG  
Designed: KS  
Drawn: KS  
Checked: KS/AN  
Plot Date: 06 Jun, 2014  
Computer File Ref: 30105-GP04-D.dwg

LEGEND	
Stage Boundary	
Townhouse (T)	
Villa (V)	
Courtyard (CY)	
Conventional (C)	
Large Conventional (LC)	

SETBACK REQUIREMENTS

Lot Type	Av. Lot Width (m)	Typical Av. Lot Size (m <sup>2</sup> )	Minimum Building Setbacks (Refer to notes below)								Private Open Space (POS)		Other Requirements Maximum Site Coverage (%)	
			First Storey				Second Storey				Minimum Area (m <sup>2</sup> )	Minimum Circle Diameter (m)		
			Front (m)	Front Garage (m)	Rear (m)	Optional Zero Lot Line	Side Setback (m)**	Front (m)	Rear (m)	Zero Lot Line				Side Setback (m)**
Townhouse (T)	10.0-12.49	320	3	5.4	3	Yes	1.0	3	3	1	1.0	80	5	50#
Villa (V)	12.5-14.99	375	3	5.4	3	Yes	1.0	3	3	1	1.5	80	5	50#
Courtyard (CY)	15.0-17.99	450	4	5.4	3	Yes	1.5	4.5	3	1.5	2	80	5	50
Conventional (C)	18.0-21.99	540	4.5	5.4	3	No	1.5	4.5	3	N/A	2	-	-	50
Large Conventional (LC)	22 & above	660	4.5	5.4	3	No	1.5	4.5	3	N/A	2	-	-	50

\*\* For non Zero Lot Line Boundary. Setbacks are measured to the wall of the building.  
# Maximum Site Coverage is 50% plus 10% for open framed elements such as patios and alfresco areas. (Refer Building Location Envelope Plan - Point 10)

Capestone - Stage 4  
Setback Plan &  
Development  
Requirements



BRISBANE (07) 3666 4700 MACKAY (07) 4951 2911 PROSERPINE (07) 4945 1722  
Email mail@thg.com.au www.thg.com.au  
ABN 55156210052 THG WSG Pty Ltd t/a THG Resource Strategists

Drawing No 30105-GP04 Issue D