

- LEGEND**
- New Hydrant
  - New Isolation Valve
  - New End Cap
  - New Scour Valve
  - New Taper
  - New Water Service Conduit (Ø100 uPVC PN9)
  - New Water Meter
  - New Water House connection

**NOTES:**

- All mains DN150 PVC-O PN16 unless noted otherwise.

**REGISTERED SURVEYOR'S CERTIFICATION**

We, Queensland Surveying Pty Ltd (ACN 604 671 374) Cadastral Surveyors, hereby certify that the vertical and horizontal locations and dimensions shown on this plan are a true and correct record and were located by survey.

Delegate (signature) *[Signature]* 6152 Registration ID 7/07/2017 Date

**ENGINEER'S CERTIFICATION**

I, DARRYL HAYTER being a Consulting Engineer and duly authorised representative of: BMD Consulting hereby certify the information contained in this drawing is an accurate "as constructed" representation of the works; I accept responsibility for the "as constructed" information contained in this drawing; and I acknowledge the "as constructed" information contained in the drawing may be relied on by the Moreton Bay Regional Council and others.

Certification for Stage 16 by *[Signature]* on 31/07/17

For: BMD CONSULTING Pty. Ltd. RPED 5694

DRAWING REVISIONS		REFERENCE DRAWINGS		DESIGN FILE No.	DESIGNED
REV.	REVISION DESCRIPTION	DRG. No.	DESCRIPTION	CONSTRUCT. No.	DATE
A	Progress Plot				7/07/2017
B	Update				7/07/2017

FIELD BOOK	LOG BOOK	LEVEL DATUM	DATUM
		AHD	PM177891

**THIS WORK WAS PREPARED BY:**  
**QUEENSLAND SURVEYING PTY LTD**

SCALE 1:500 ORIGINAL SIZE A1

**MORETON BAY REGIONAL COUNCIL**  
 CABOOLTURE DISTRICT OFFICE  
 2 HASKING STREET CABOOLTURE QLD 4510  
 PO BOX 159 CABOOLTURE QLD 4510  
 Telephone: (07) 5433 0100  
 Fax: (07) 5433 4000

**STAGE 16, CAPESTONE**  
**AS CONSTRUCTED**  
**WATER RETICULATION**

MBRC SUBDIVISION REFERENCE  
 DA/31730/2016/V23R  
 No. 1 OF 2 PLANS  
 DRAWING NUMBER REV.  
 30105-160100 AW B

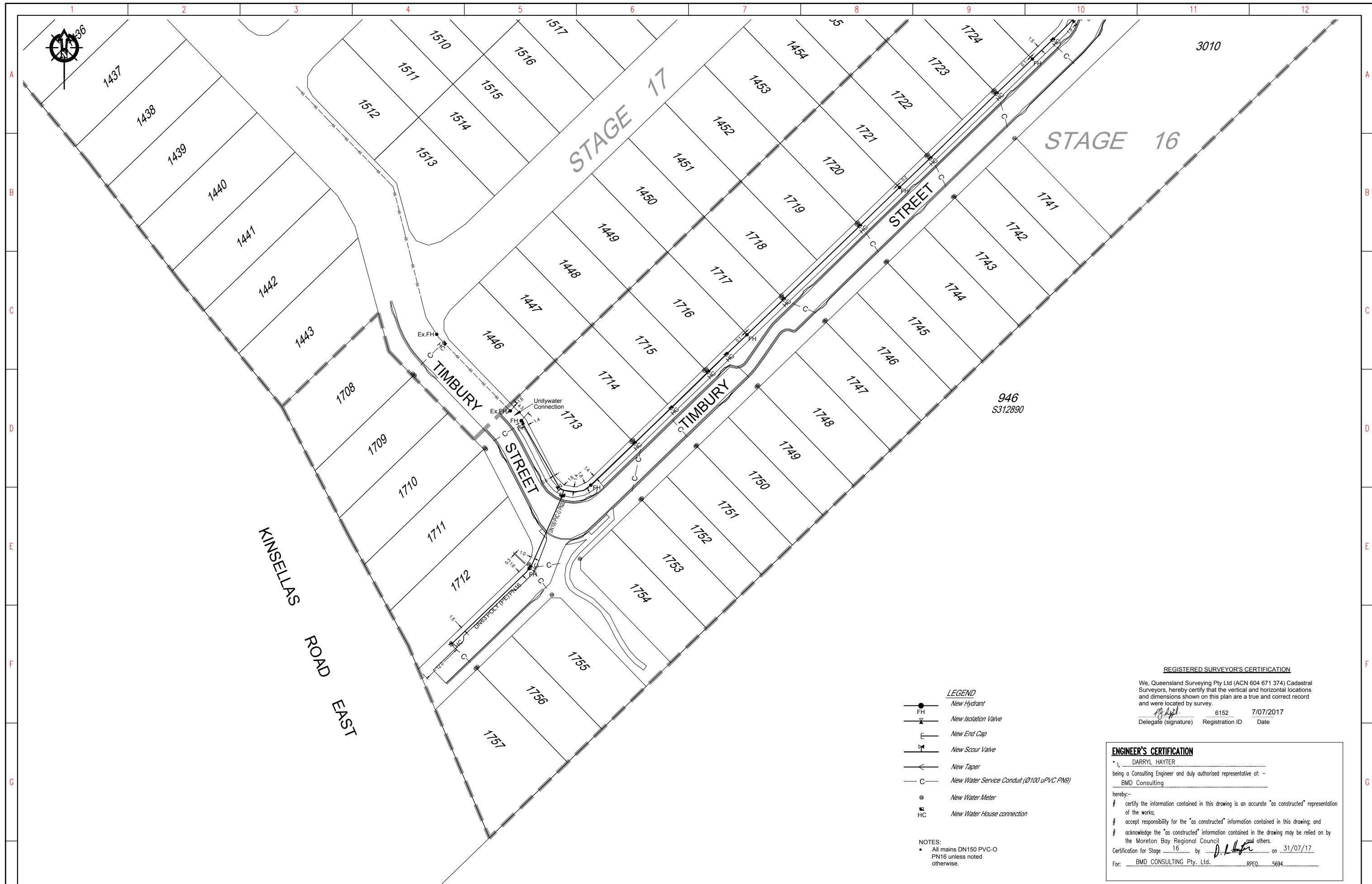

**REGISTERED SURVEYOR'S CERTIFICATION**

We, Queensland Surveying Pty Ltd (ACN 604 671 374) Cadastral Surveyors, hereby certify that the vertical and horizontal locations and dimensions shown on this plan are a true and correct record and were located by survey.

*[Signature]* 6152 7/07/2017  
 Delegate (signature) Registration ID Date

**LEGEND**

- New Hydrant
- New Isolation Valve
- New End Cap
- New Scour Valve
- New Taper
- New Water Service Conduit (Ø100 uPVC PN9)
- New Water Meter
- New Water House connection

NOTES:  
 • All mains DN150 PVC-O PN16 unless noted otherwise.

**ENGINEER'S CERTIFICATION**

I, DARRYL HAYTER  
 being a Consulting Engineer and duly authorised representative of: -  
BMD Consulting  
 hereby:-  
 # certify the information contained in this drawing is an accurate "as constructed" representation of the works;  
 # accept responsibility for the "as constructed" information contained in this drawing; and  
 # acknowledge the "as constructed" information contained in the drawing may be relied on by the Moreton Bay Regional Council and others.  
 Certification for Stage 16 by [Signature] on 31/07/17  
 For: BMD CONSULTING Pty. Ltd. RPEQ 5694

DRAWING REVISIONS		REFERENCE DRAWINGS		DESIGN FILE No.	DESIGNED
REV.	REVISION DESCRIPTION	DRG. No.	DESCRIPTION	CONSTRUCT. No.	DATE
A	Progress Plot				
B	Update				

FIELD BOOK	LOG BOOK	LEVEL DATUM	DATUM
		AHD	PM177891

**THIS WORK WAS PREPARED BY:  
 QUEENSLAND SURVEYING PTY LTD**



**MORETON BAY REGIONAL COUNCIL**  
 CABOOLTURE DISTRICT OFFICE  
 2 HASKING STREET CABOOLTURE QLD 4510  
 PO BOX 159 CABOOLTURE QLD 4510  
 Telephone: (07) 5433 0100  
 Fax: (07) 5433 4000

**STAGE 16, CAPESTONE  
 AS CONSTRUCTED  
 WATER RETICULATION**

SCALE 1:500 ORIGINAL SIZE A1

MBRC SUBDIVISION REFERENCE	
DA/31730/2016/V23R	
No. 2 OF 2 PLANS	
DRAWING NUMBER	REV.
30105-160100 AW	B