

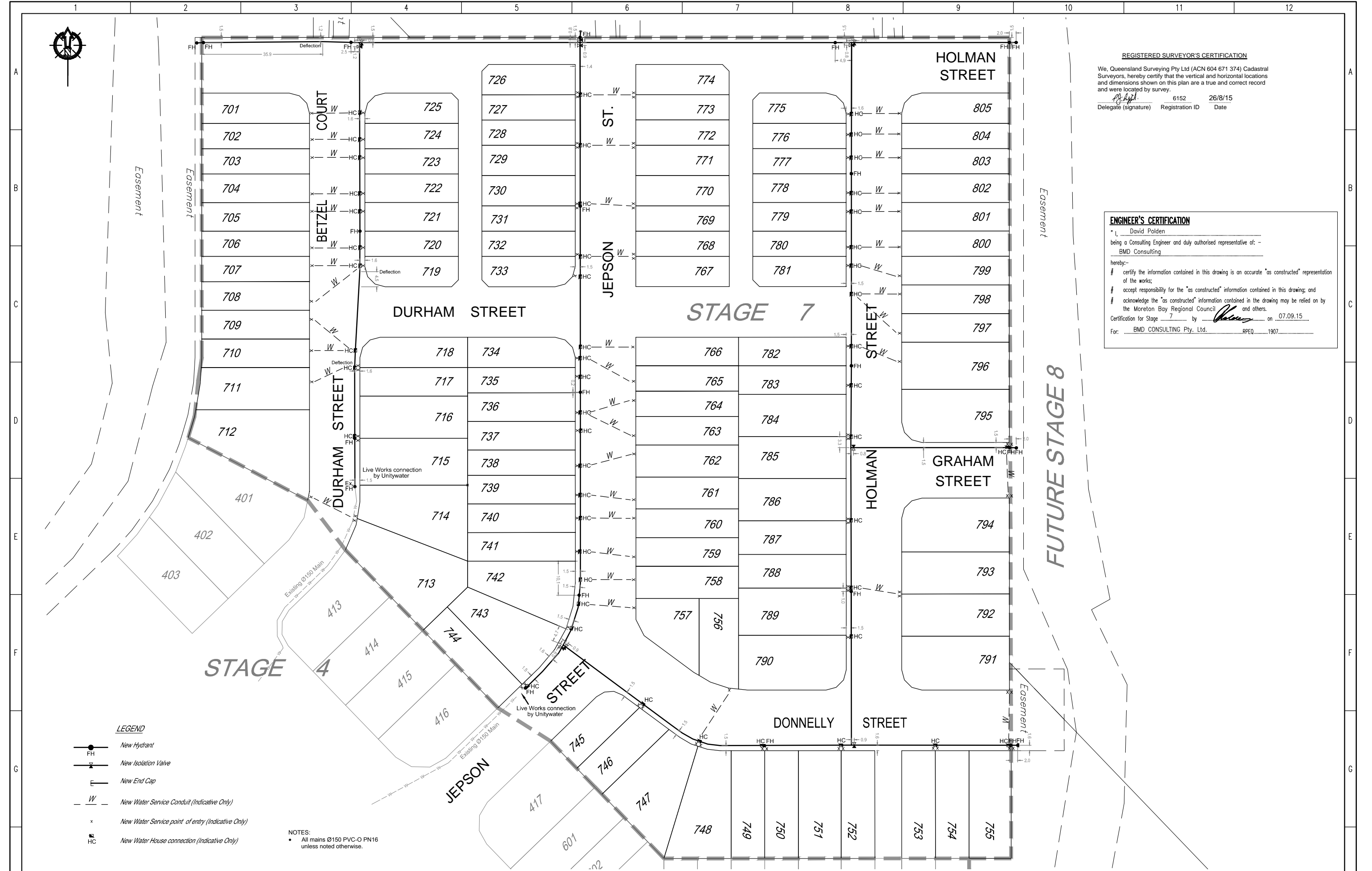

REGISTERED SURVEYOR'S CERTIFICATION
 We, Queensland Surveying Pty Ltd (ACN 604 671 374) Cadastral Surveyors, hereby certify that the vertical and horizontal locations and dimensions shown on this plan are a true and correct record and were located by survey.
 Delegate (signature) *[Signature]* 6152 26/8/15
 Registration ID Date

ENGINEER'S CERTIFICATION
 I, David Polden
 being a Consulting Engineer and duly authorised representative of: -
 BMD Consulting
 hereby:-
 # certify the information contained in this drawing is an accurate "as constructed" representation of the works;
 # accept responsibility for the "as constructed" information contained in this drawing; and
 # acknowledge the "as constructed" information contained in the drawing may be relied on by the Moreton Bay Regional Council and others.
 Certification for Stage 7 by *[Signature]* on 07.09.15
 For: BMD CONSULTING Pty. Ltd. RPEQ 1907



- LEGEND**
- New Hydrant
 - New Isolation Valve
 - New End Cap
 - New Water Service Conduit (Indicative Only)
 - New Water Service point of entry (Indicative Only)
 - New Water House connection (Indicative Only)

NOTES:
 • All mains Ø150 PVC-O PN16 unless noted otherwise.

DRAWING REVISIONS		REFERENCE DRAWINGS		DESIGN FILE No.	DESIGNED
REV.	REVISION DESCRIPTION	DRG. No.	DESCRIPTION	CONSTRUCT. No.	DATE
B	Original			SURVEY FILE No. 80105-070100 AW	DRAWN EJM DATE 26/8/15
C	Add FH			LOG BOOK	CHECKED EJM DATE 26/8/15
				LEVEL DATUM	AHD
				DATUM	PM177891

**THIS WORK WAS PREPARED BY:
 QUEENSLAND SURVEYING PTY LTD**



MORETON BAY REGIONAL COUNCIL
 CABOOLTURE DISTRICT OFFICE
 2 HASKING STREET CABOOLTURE QLD 4510
 PO BOX 159 CABOOLTURE QLD 4510
 Telephone: (07) 5433 0100
 Fax: (07) 5433 4000

**STAGE 7, CAPESTONE
 AS CONSTRUCTED
 WATER RETICULATION**

SCALE 1:500 ORIGINAL SIZE A1

MBRC SUBDIVISION REFERENCE	
DA/29345/2014/V4DU	
No. 1 OF 1 PLANS	
ASCAN GRID NUMBER	REV.
	C