



I, Peter Sippel, being a cadastral surveyor and duly authorised representative of THG WSG Pty Ltd hereby:

- certify the information contained in this drawing is an accurate as constructed representation of the works
- accept responsibility for the as constructed information contained in this drawing
- acknowledge the as constructed information contained in the drawing may be relied on by council and others

Certification of Stage 5  
 by *P. Sippel* on 12/1/15  
 (Signature) (Date)

for THG WSG Pty Ltd

**ENGINEER'S CERTIFICATION**

I, David Polden, being a Consulting Engineer and duly authorised representative of: - BMD Consulting hereby:

- certify the information contained in this drawing is an accurate "as constructed" representation of the works;
- accept responsibility for the "as constructed" information contained in this drawing; and
- acknowledge the "as constructed" information contained in the drawing may be relied on by the Moreton Bay Regional Council and others.

Certification of Stage 5 by *David Polden* on 13.02.15

For: BMD CONSULTING Pty. Ltd. RPEQ 1907

DRAWING REVISIONS		REFERENCE DRAWINGS		DESIGN FILE No.	DESIGNED
REV.	REVISION DESCRIPTION	DRG. No.	DESCRIPTION	CONSTRUCT. No.	DATE
A	Original			247405_9 ARD	12/1/15
				FIELD BOOK	12/1/15
				LOG BOOK	12/1/15
				LEVEL DATUM	
				DATUM	

**THIS WORK WAS PREPARED BY:**  
**THG WSG PTY LTD**

SCALE 1:500 ORIGINAL SIZE A1

**MORETON BAY REGIONAL COUNCIL**  
 CABOOLTURE DISTRICT OFFICE  
 2 HASKING STREET CABOOLTURE QLD 4510  
 PO BOX 159 CABOOLTURE QLD 4510  
 Telephone: (07) 5433 0100  
 Fax: (07) 5433 4000

**STAGE 5, CAPESTONE**  
**AS CONSTRUCTED**  
**ROADS AND DRAINAGE**

MBRC SUBDIVISION REFERENCE	
DA/28463/2013/V23R	
No. 1 OF 2 PLANS	REV.
ASCEN GRID NUMBER	46188
	A

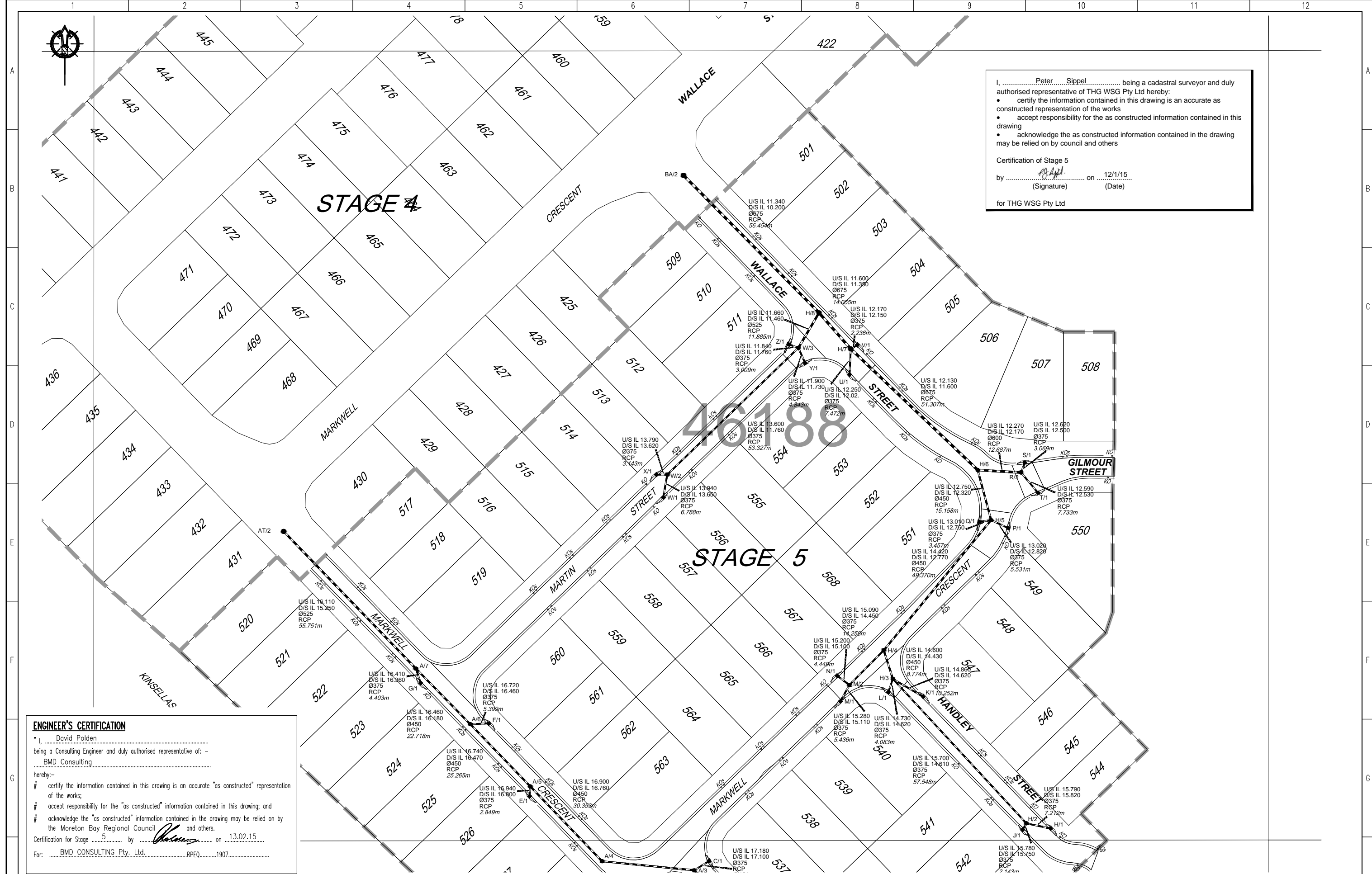

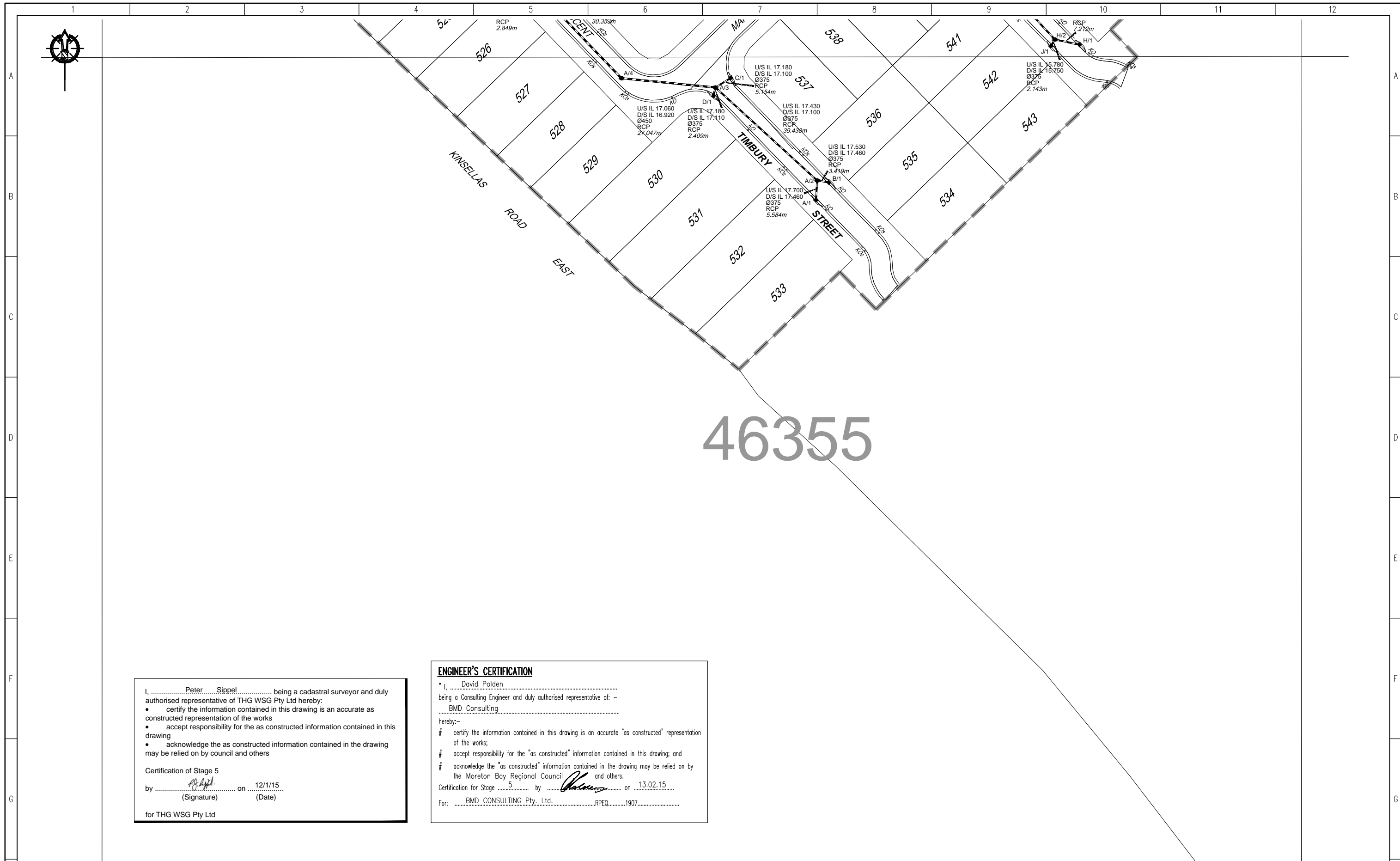

I, Peter Sippel, being a cadastral surveyor and duly authorised representative of THG WSG Pty Ltd hereby:

- certify the information contained in this drawing is an accurate as constructed representation of the works
- accept responsibility for the as constructed information contained in this drawing
- acknowledge the as constructed information contained in the drawing may be relied on by council and others

Certification of Stage 5  
 by P. Sippel on 12/1/15  
 (Signature) (Date)

for THG WSG Pty Ltd

**ENGINEER'S CERTIFICATION**

I, David Polden, being a Consulting Engineer and duly authorised representative of: -  
BMD Consulting  
 hereby:-

- certify the information contained in this drawing is an accurate "as constructed" representation of the works;
- accept responsibility for the "as constructed" information contained in this drawing; and
- acknowledge the "as constructed" information contained in the drawing may be relied on by the Moreton Bay Regional Council and others.

Certification for Stage 5 by [Signature] on 13.02.15  
 For: BMD CONSULTING Pty. Ltd. RPEQ. 1907

DRAWING REVISIONS		REFERENCE DRAWINGS		DESIGN FILE No.	DESIGNED
REV.	REVISION DESCRIPTION	DRG. No.	DESCRIPTION	CONSTRUCT. No.	DATE
A	Original				
				SURVEY FILE No. 247405_9 ARD	DRAWN EJM
				FIELD BOOK	DATE 12/1/15
				LOG BOOK	CHECKED EJM
				LEVEL DATUM AHD	DATE 12/1/15
				DATUM PM177891	

**THIS WORK WAS PREPARED BY:**  
**THG WSG PTY LTD**



**MORETON BAY REGIONAL COUNCIL**  
 CABOOLTURE DISTRICT OFFICE  
 2 HASKING STREET CABOOLTURE QLD 4510  
 PO BOX 159 CABOOLTURE QLD 4510  
 Telephone: (07) 5433 0100  
 Fax: (07) 5433 4000

**STAGE 5, CAPESTONE AS CONSTRUCTED ROADS AND DRAINAGE**

SCALE 1:500 ORIGINAL SIZE A1

MBRC SUBDIVISION REFERENCE	
DA/28463/2013/V23R	
No. 2 OF 2 PLANS	
ASCEN GRID NUMBER	REV.
46355	A