

946
S312890

- NOTES:**
- All new mains DN150 PVC-U SN8 unless noted otherwise.
 - Existing sewer mains DN300PVC-U PN12 between Ex9/1 and Ex3/Ext3, DN225PVC-U PN12 between Ex3/Ext3 and Ex17/Ext3.
 - All property connections are DN100 PVC-U

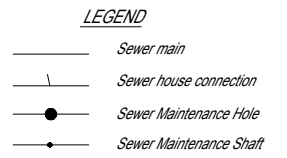

ENGINEER'S CERTIFICATION

I, DARRYL HAYTER
being a Consulting Engineer and duly authorised representative of: -
EMPOWER ENGINEERS AND PROJECT MANAGERS
hereby:-
certify the information contained in this drawing is an accurate "as constructed" representation of the works;
accept responsibility for the "as constructed" information contained in this drawing; and
acknowledge the "as constructed" information contained in the drawing may be relied on by the Moreton Bay Regional Council and others.
Certification for Stage 14 by D.L.H. on 28/08/17
For: EMPOWER ENGINEERS AND PROJECT MANAGERS RPEQ 5694

REGISTERED SURVEYOR'S CERTIFICATION

We, Queensland Surveying Pty Ltd (ACN 604 671 374) Cadastral Surveyors, hereby certify that the vertical and horizontal locations and dimensions shown on this plan are a true and correct record and were located by survey.

[Signature] 6152 23/8/2017
Delegate (signature) Registration ID Date

DRAWING REVISIONS		REFERENCE DRAWINGS		DESIGN FILE No.	DESIGNED
REV.	REVISION DESCRIPTION	DRG. No.	DESCRIPTION	CONSTRUCT. No.	DATE
A	Progress Plot				
B	Update				
C	Update				

FIELD BOOK	LOG BOOK	LEVEL DATUM	DATUM
		AHD	PM177891

THIS WORK WAS PREPARED BY:
QUEENSLAND SURVEYING PTY LTD

SCALE 1:500 ORIGINAL SIZE A1

MORETON BAY REGIONAL COUNCIL
CABOOLTURE DISTRICT OFFICE
2 HASKING STREET CABOOLTURE QLD 4510
Telephone: (07) 5433 0100
Fax: (07) 5433 4000

STAGE 14, CAPESTONE
AS CONSTRUCTED
SEWER RETICULATION

MBCR SUBDIVISION REFERENCE
DA/31223/2016/V23R
No. 1 OF 2 PLANS
DRAWING NUMBER REV.
30105-140100 AS C

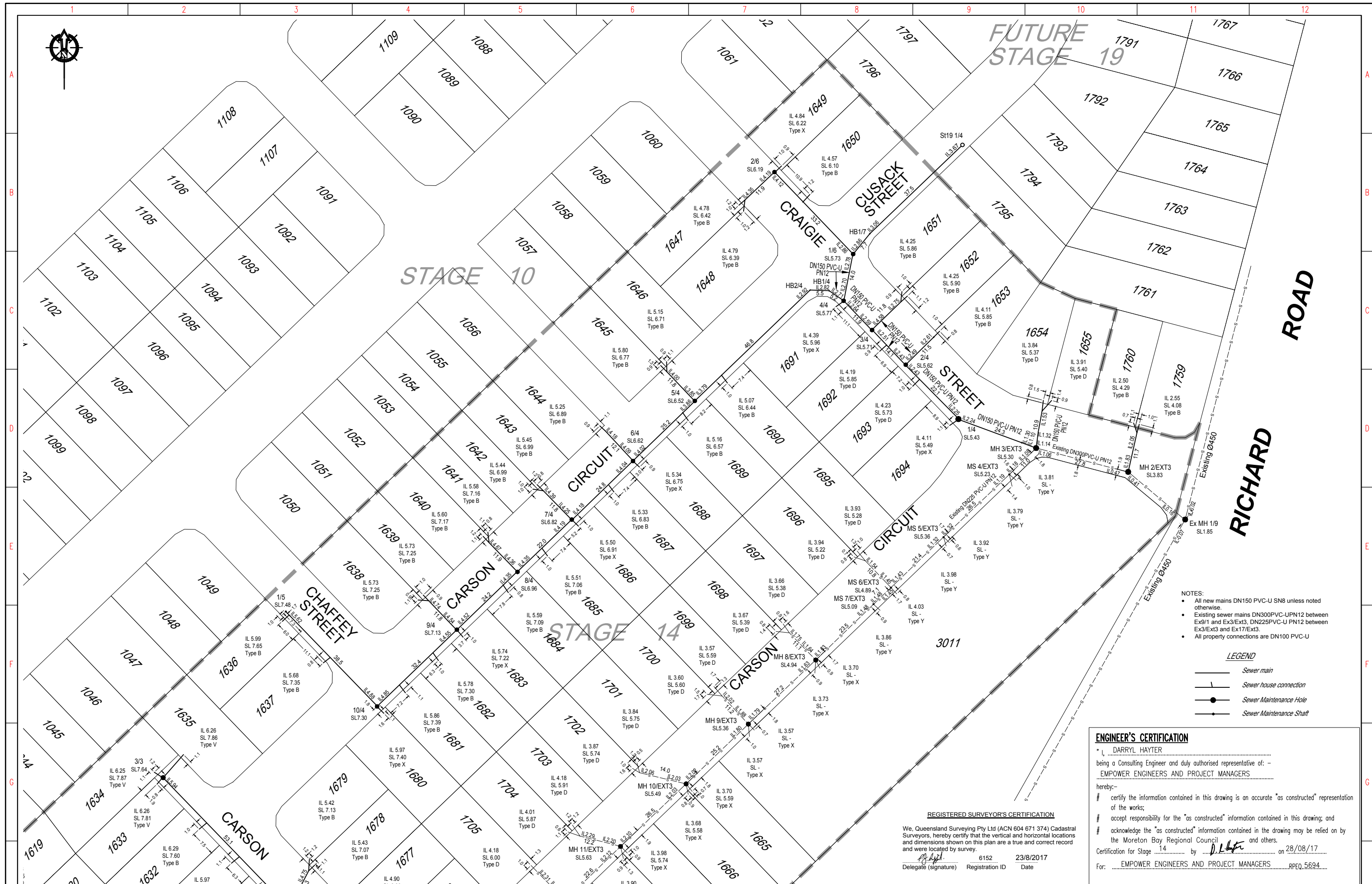

- NOTES:**
- All new mains DN150 PVC-U SN8 unless noted otherwise.
 - Existing sewer mains DN300PVC-UPN12 between Ex9/1 and Ex3/Ext3, DN225PVC-U PN12 between Ex3/Ext3 and Ex17/Ext3.
 - All property connections are DN100 PVC-U

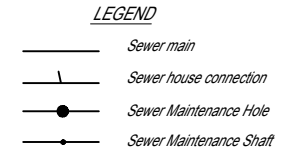

ENGINEER'S CERTIFICATION

I, DARRYL HAYTER,
 being a Consulting Engineer and duly authorised representative of: -
EMPOWER ENGINEERS AND PROJECT MANAGERS
 hereby:-
 # certify the information contained in this drawing is an accurate "as constructed" representation of the works;
 # accept responsibility for the "as constructed" information contained in this drawing; and
 # acknowledge the "as constructed" information contained in the drawing may be relied on by the Moreton Bay Regional Council and others.
 Certification for Stage 14 by D. Hayer on 28/08/17
 For: EMPOWER ENGINEERS AND PROJECT MANAGERS RPEQ 5694

REGISTERED SURVEYOR'S CERTIFICATION

We, Queensland Surveying Pty Ltd (ACN 604 671 374) Cadastral Surveyors, hereby certify that the vertical and horizontal locations and dimensions shown on this plan are a true and correct record and were located by survey.

D. Hayer 6152 23/8/2017
 Delegate (signature) Registration ID Date

DRAWING REVISIONS		REFERENCE DRAWINGS		DESIGN FILE No.		DESIGNED	
REV.	REVISION DESCRIPTION	DRG. No.	DESCRIPTION	CONSTRUCT. No.	DATE	DATE	DATE
A	Progress Plot					23/8/17	EJM
B	Update						EJM
C	Update						EJM

THIS WORK WAS PREPARED BY:
QUEENSLAND SURVEYING PTY LTD

SCALE 1:500 ORIGINAL SIZE A1



MORETON BAY REGIONAL COUNCIL
 CABOOLTURE DISTRICT OFFICE
 2 HASKING STREET CABOOLTURE QLD 4510
 Telephone: (07) 5433 0100
 Fax: (07) 5433 4000

STAGE 14, CAPESTONE
AS CONSTRUCTED
SEWER RETICULATION

MBRC SUBDIVISION REFERENCE	
DA/31223/2016/V23R	
No. 2 OF 2 PLANS	
DRAWING NUMBER	REV.
30105-140100 AS	C